



BINGHATTI
AQUARISE



بن غاطي
BINGHATTI



AMIDST SILK AND SUNSHINE,
A WHISPER OF HAUTE COUTURE DRIFTS.

Recall the Crystal Shores *of the Azure Coast*

WHERE ELEGANCE REIGNED

Inspired by the sinuous curves of water, Aquarise façade is a testament to fluidity. A dance of glass and light, reflecting the ever-changing hues of the Dubai sky. An ode to Binghatti's visionary design, where architecture becomes art.

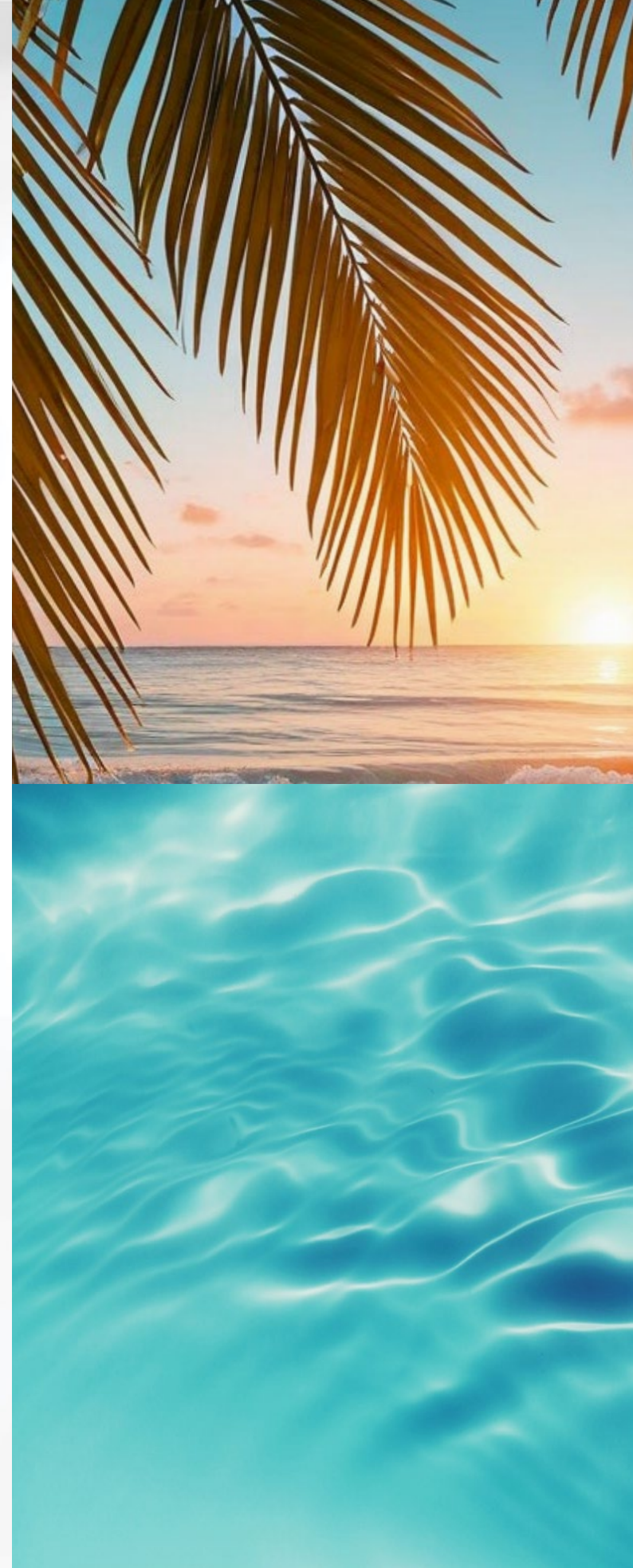



Delve Deeper *into the* Heart of Aquarise

Where every element is a testament to Binghatti's pursuit of harmonious living. Residences are crafted with exquisite materials, inviting touch and inspiring calm.

Feel the cool embrace of polished marble, the warmth of natural wood,
the subtle textures that whisper of refinement.

Each detail, meticulously chosen to create a rippling escape.





Reconnect *with the*
Richness *of* Life

Within the walls of Aquarise, discover an elixir for the soul.
A sanctuary where time slows to a graceful turn. Reconnect with
the richness of life, with yourself. Lose yourself in the tranquility
of the moment, in the undeniable joy of être.



AN ELIXIR REACHING FOR THE SKY

A Flow of Life *that* Transcends *the* Ordinary

Come, wade gently into the flow. Escape the city's relentless rhythm, and discover a harbour where life finds its natural cadence. Aquarise, a shimmering oasis of glass and steel, an ode to the ebb amidst the constance of **Business Bay**

AQUARISE

Embrace *the* Current

Aquarise, nestled in the **heart of Business Bay**. Steps away from the **Dubai Canal**, a stone's throw from **Downtown Dubai**. Immersed in the city's energy, yet a world apart. A place where you can embrace the current, yet find your own gentle flow.

-  **Burj Khalifa & Dubai Mall**
5 minutes
-  **Dubai Opera**
5 minutes
-  **Dubai International Financial Centre**
10 minutes
-  **Museum of the Future**
12 minutes
-  **The Meydan Hotel & Race Course**
12 minutes
-  **Burj Al Arab & Jumeirah Beach**
15 minutes
-  **Dubai International Airport (DXB)**
16 minutes
-  **Dubai Harbour**
16 minutes
-  **Dubai Creek Golf & Yacht Club**
16 minutes
-  **Palm Jumeirah**
18 minutes



Like a *wave*, it rises.
A shimmering *vision*.
Reside *in its* replenishment.





PROJECT FACTS

A Curated Collection *of* Residences

PROPERTY TYPE:
Residential & Retails

PLOT AREA:
21589.98 SQ.M / 232392.38 SQ.FT

DESCRIPTION:
3B + G + Mezzanine + 25 Residential Floors
+ Mechanical Room + Roof

NUMBER OF UNITS:

| | |
|------------|-----|
| Studio: | 688 |
| 1 Bedroom: | 736 |
| 2 Bedroom: | 152 |
| 3 Bedroom: | 10 |
| 4 Bedroom: | 12 |

TOTAL UNITS:

| | |
|-------------------------|------|
| Residential Units: | 1598 |
| Retails (Ground Floor): | 28 |





بن غاطي
BINGHATTI



UNPARALLELED COMFORT, FLOWING DESIGN

Interiors *that* Whisper *of* Elegance

Premium materials, meticulously chosen.
Spaces designed for comfort, for serenity,
for the undeniable joy of être. Every detail,
a testament to Binghatti's commitment
to creating residences that transcend
the ordinary.

AQUARISE









Reconnect *with the*
Richness *of* Life

A residence for those who appreciate the art of living well.
For those who seek more than a home. Aquarise.
A dream in blue, realised.





A Palette *of* Replenishment

Subtle hues, inspired by the azure coast. Rich textures, inviting touch. A palette of elegance, where sophistication reigns. Interiors designed to soothe the senses and inspire tranquility.





PROJECT AMENITIES

Feel *the* Gentle Pull *of* Life

Aquarise offers a curated collection of amenities, each designed to replenish and inspire.



POOL DECK



GYM & FITNESS



SUNKEN SEATING



LUXURY LOBBY



ARTIFICIAL BEACH



RUNNING LANE



SKYLINE VIEW



PLAY AREA



SKY GARDEN



PADEL COURT



HALF BASKETBALL

Aquarise is your personal oasis, a place to reconnect with your essence and embrace the current

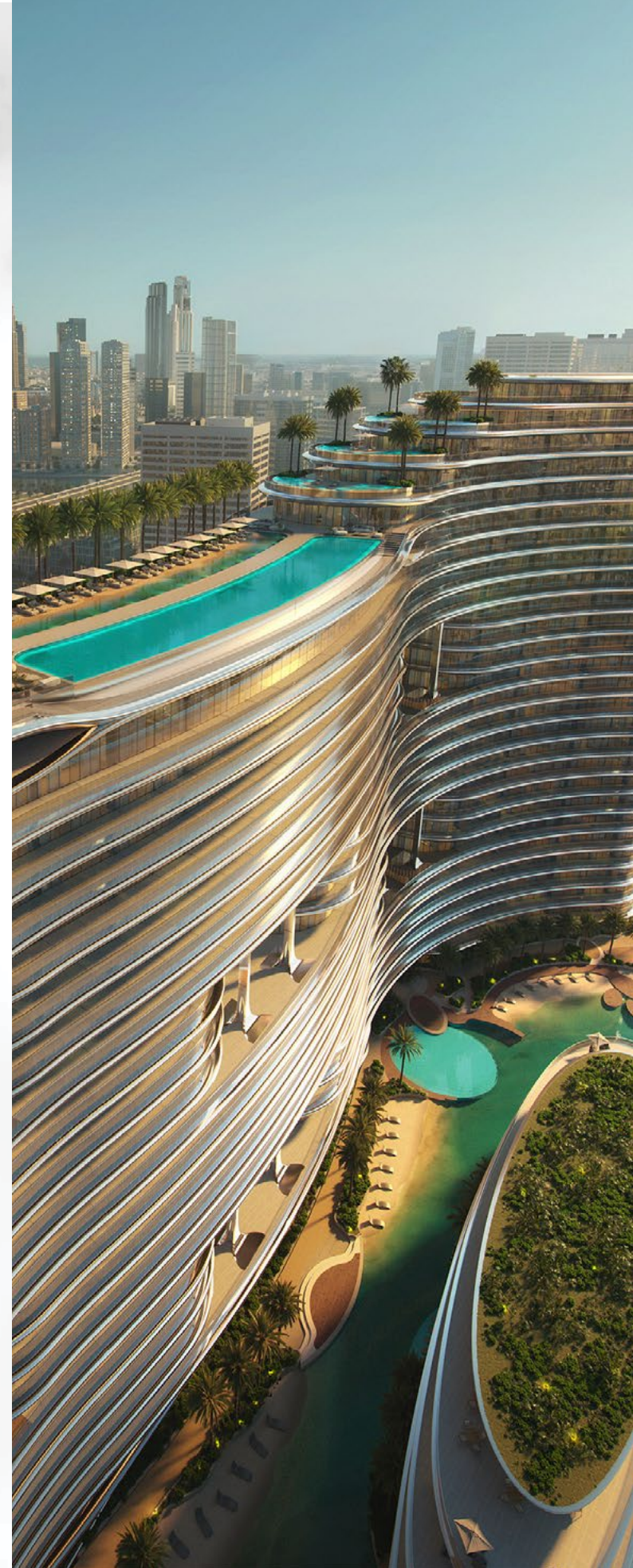

Built on a Foundation of Quality *and* Craftsmanship

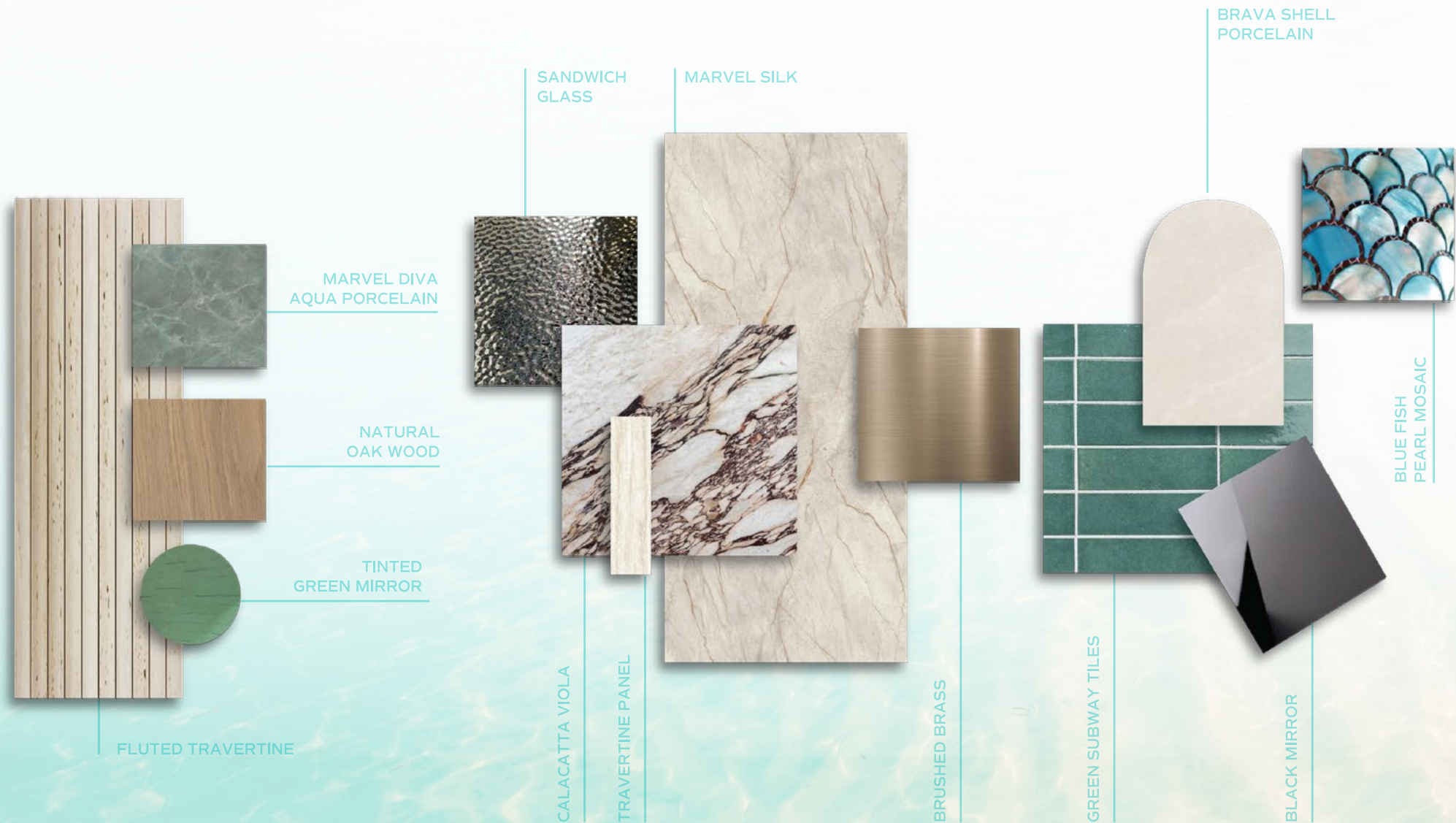

Binghatti's commitment to excellence is reflected in every detail from sustainable materials to energy-efficient design. Aquarise stands as a testament to a legacy of crafting spaces that are both refined and responsibly built.





A Building *that* Embodies *the* Very Essence *of* Flow

The wave-like structure, an architectural feat.
Reflective façades, capturing the dynamism
of the city. Terraces that extend your living space,
blurring the lines between indoors and out.

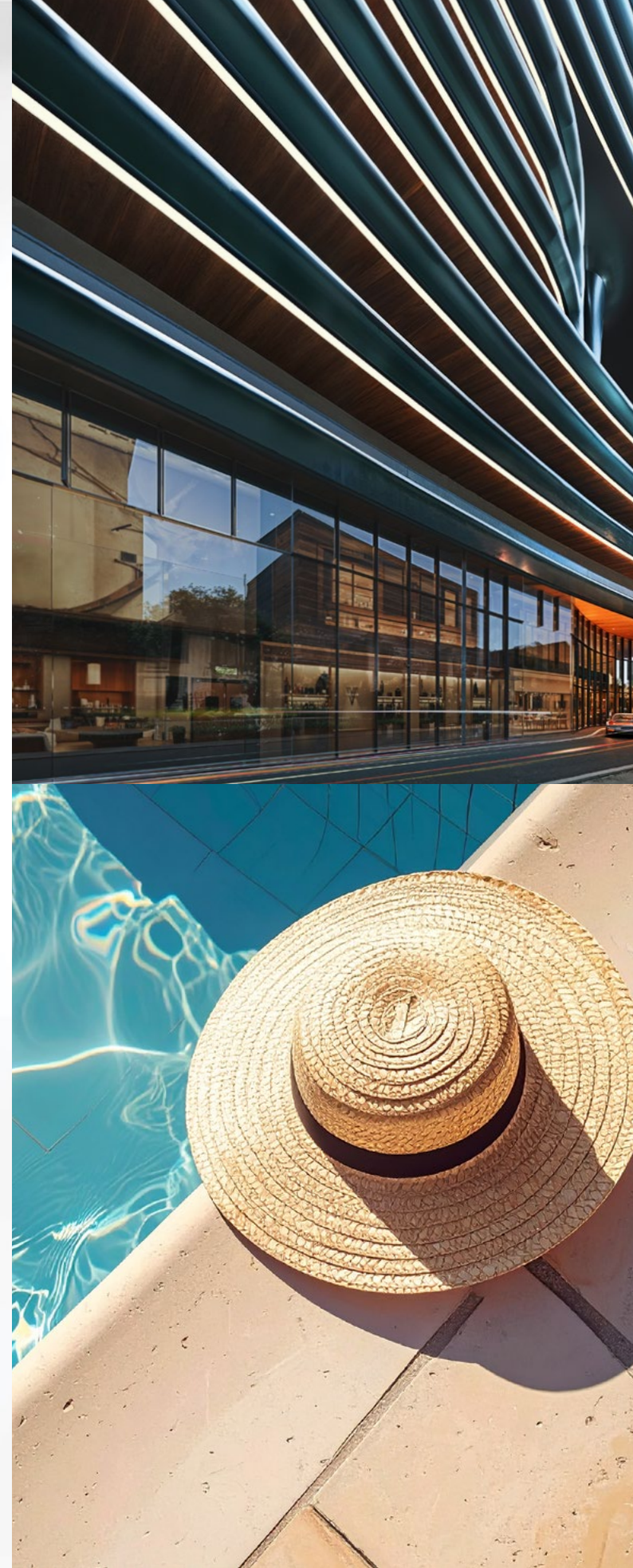



FLOOR PLANS

Layouts Crafted *for* Comfort *and* Space



Discover a range of thoughtfully designed floor plans to suit your individual needs and lifestyle. From studios to penthouses, Aquarise offers a space for everyone.



UNIT TYPE - STUDIO

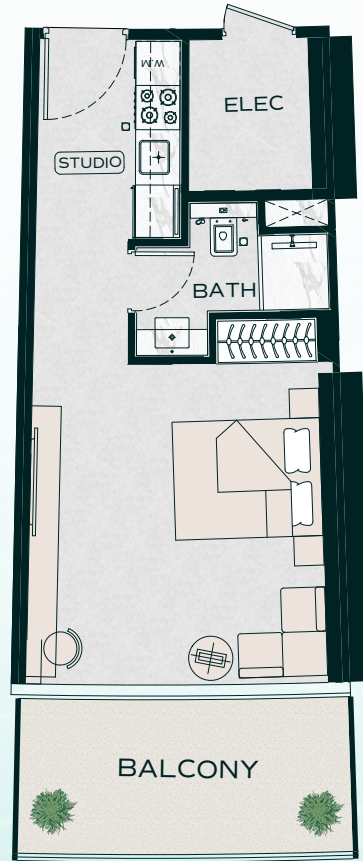

STUDIO TYPE -01

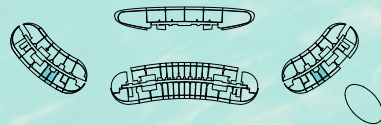

| AREA | SQ.M | SQ.FT |
|-----------------|----------------------|------------------------|
| AREA SUITE | 33.54 m ² | 361.02 ft ² |
| BALCONY AREA | 9.93 m ² | 106.89 ft ² |
| TOTAL UNIT AREA | 43.47 m ² | 467.91 ft ² |

FLAT DESIGN COMPONENTS

| | |
|---------|------------------|
| BATH | 4 m ² |
| STUDIO | 21 m |
| KITCHEN | 5 m ² |

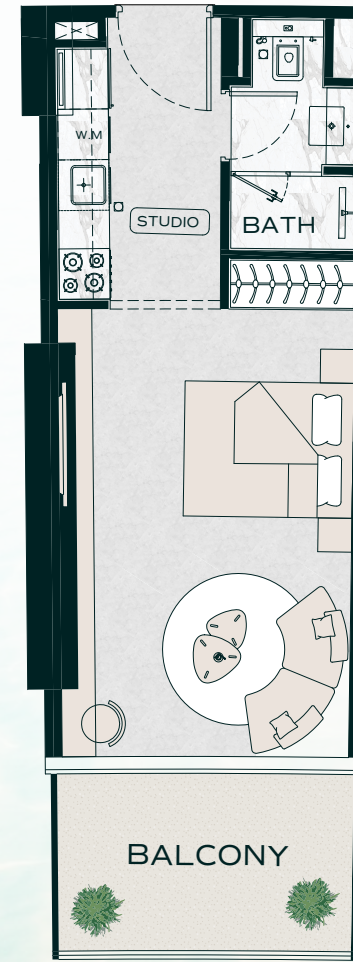

STUDIO TYPE -02

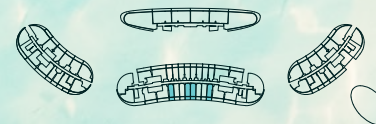

| AREA | SQ.M | SQ.FT |
|-----------------|----------------------|------------------------|
| AREA SUITE | 32.65 m ² | 351.44 ft ² |
| BALCONY AREA | 7.75 m ² | 83.42 ft ² |
| TOTAL UNIT AREA | 40.40 m ² | 434.86 ft ² |

FLAT DESIGN COMPONENTS

| | |
|---------|------------------|
| BATH | 4 m ² |
| STUDIO | 19 m |
| KITCHEN | 6 m ² |

UNIT TYPE - STUDIO



STUDIO TYPE -03

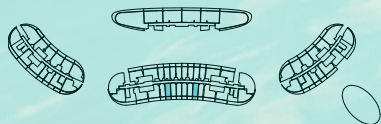

| AREA | SQ.M | SQ.FT |
|-----------------|----------------------|------------------------|
| AREA SUITE | 33.23 m ² | 357.68 ft ² |
| BALCONY AREA | 7.75 m ² | 83.42 ft ² |
| TOTAL UNIT AREA | 40.98 m ² | 441.11 ft ² |

FLAT DESIGN COMPONENTS

| | |
|---------|-------------------|
| BATH | 4 m ² |
| STUDIO | 19 m ² |
| KITCHEN | 6 m ² |

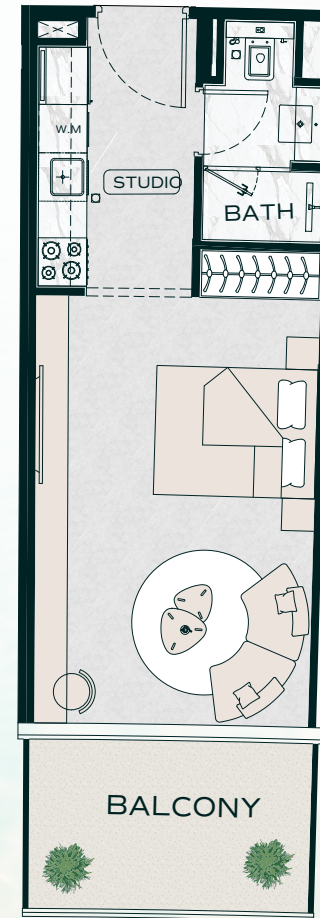

STUDIO TYPE -04

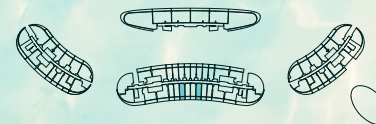

| AREA | SQ.M | SQ.FT |
|-----------------|----------------------|------------------------|
| AREA SUITE | 32.65 m ² | 351.44 ft ² |
| BALCONY AREA | 7.75 m ² | 83.42 ft ² |
| TOTAL UNIT AREA | 40.40 m ² | 434.86 ft ² |

FLAT DESIGN COMPONENTS

| | |
|---------|-------------------|
| BATH | 4 m ² |
| STUDIO | 19 m ² |
| KITCHEN | 7 m ² |

UNIT TYPE - STUDIO

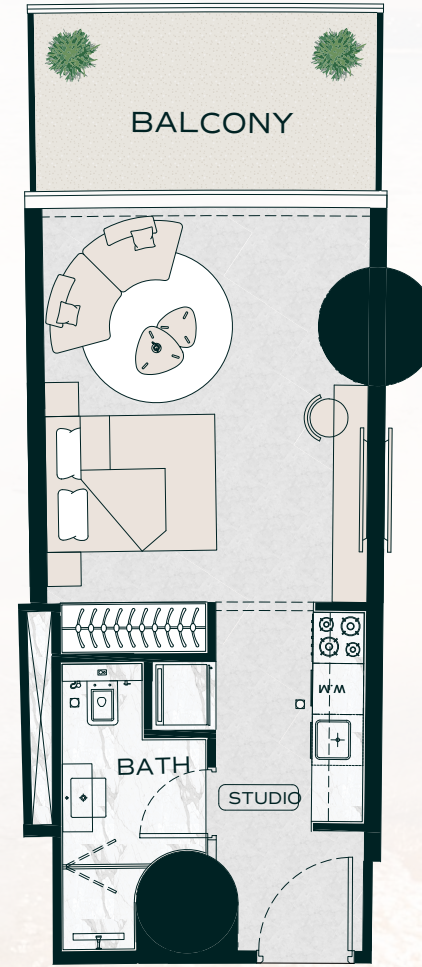
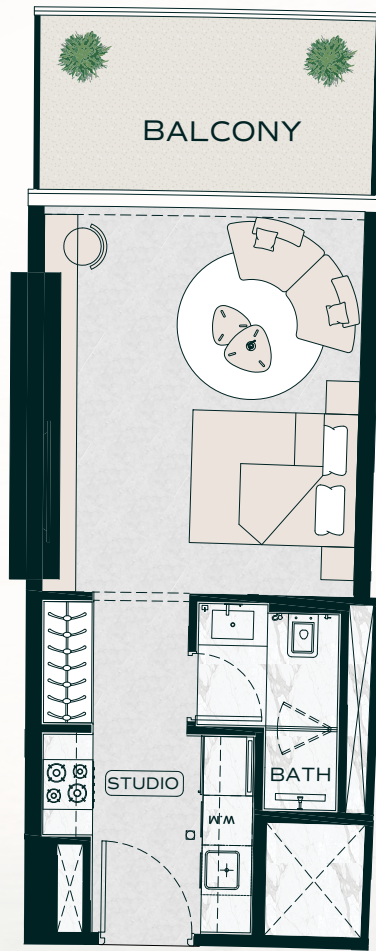

STUDIO TYPE -05

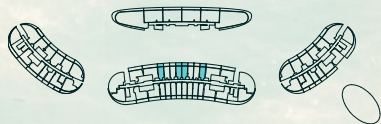

| AREA | SQ.M | SQ.FT |
|-----------------|----------------------|------------------------|
| AREA SUITE | 32.68 m ² | 351.76 ft ² |
| BALCONY AREA | 8.90 m ² | 95.80 ft ² |
| TOTAL UNIT AREA | 41.58 m ² | 447.56 ft ² |

FLAT DESIGN COMPONENTS

| | |
|---------|-------------------|
| BATH | 4 m ² |
| STUDIO | 20 m ² |
| KITCHEN | 7 m ² |

STUDIO TYPE -06

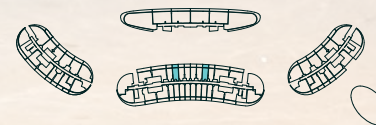

| AREA | SQ.M | SQ.FT |
|-----------------|----------------------|------------------------|
| AREA SUITE | 34.88 m ² | 375.45 ft ² |
| BALCONY AREA | 8.90 m ² | 95.80 ft ² |
| TOTAL UNIT AREA | 43.78 m ² | 471.24 ft ² |

FLAT DESIGN COMPONENTS

| | |
|---------|-------------------|
| BATH | 4 m ² |
| STUDIO | 18 m ² |
| KITCHEN | 7 m ² |
| LAUNDRY | 1 m ² |

UNIT TYPE - STUDIO

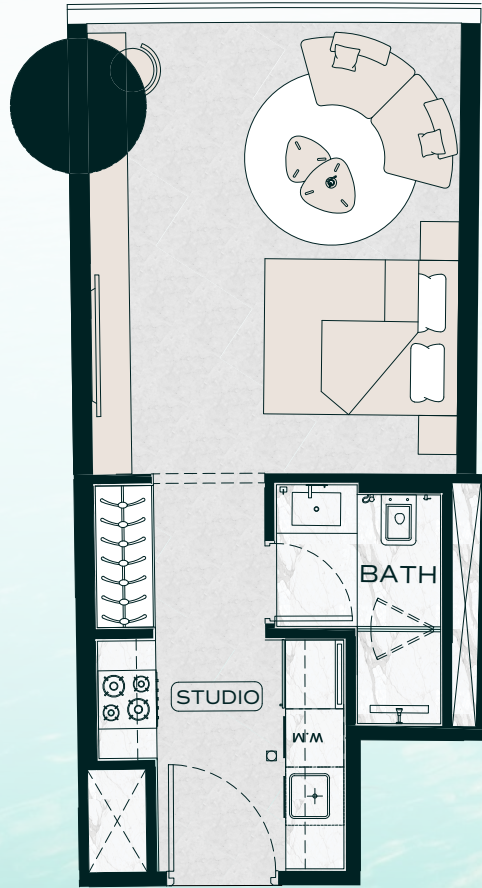

STUDIO TYPE -07

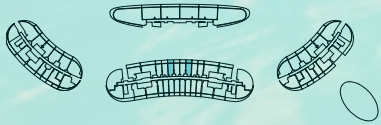

| AREA | SQ.M | SQ.FT |
|-----------------|----------------------|------------------------|
| AREA SUITE | 32.68 m ² | 351.76 ft ² |
| BALCONY AREA | 8.90 m ² | 95.80 ft ² |
| TOTAL UNIT AREA | 41.58 m ² | 447.56 ft ² |

FLAT DESIGN COMPONENTS

| | |
|---------|-------------------|
| BATH | 4 m ² |
| STUDIO | 21 m ² |
| KITCHEN | 6 m ² |

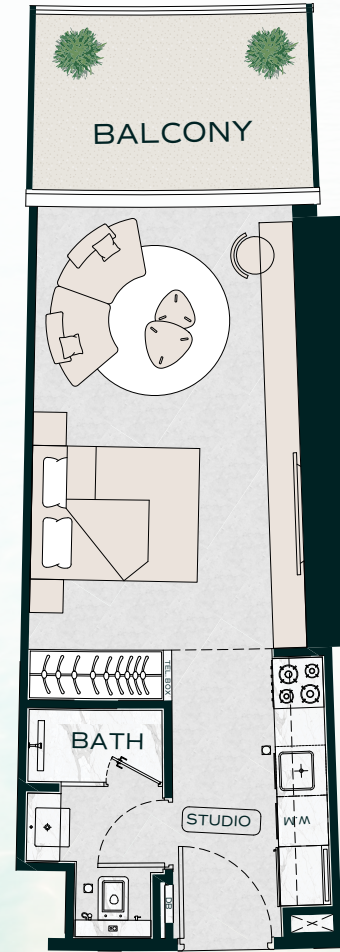

STUDIO TYPE -08

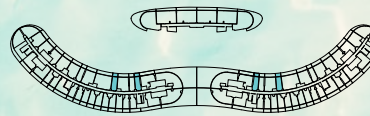

| AREA | SQ.M | SQ.FT |
|-----------------|----------------------|------------------------|
| AREA SUITE | 32.24 m ² | 347.03 ft ² |
| BALCONY AREA | 7.34 m ² | 79.01 ft ² |
| TOTAL UNIT AREA | 39.58 m ² | 426.04 ft ² |

FLAT DESIGN COMPONENTS

| | |
|---------|-------------------|
| BATH | 4 m ² |
| STUDIO | 18 m ² |
| KITCHEN | 6 m ² |

UNIT TYPE - STUDIO

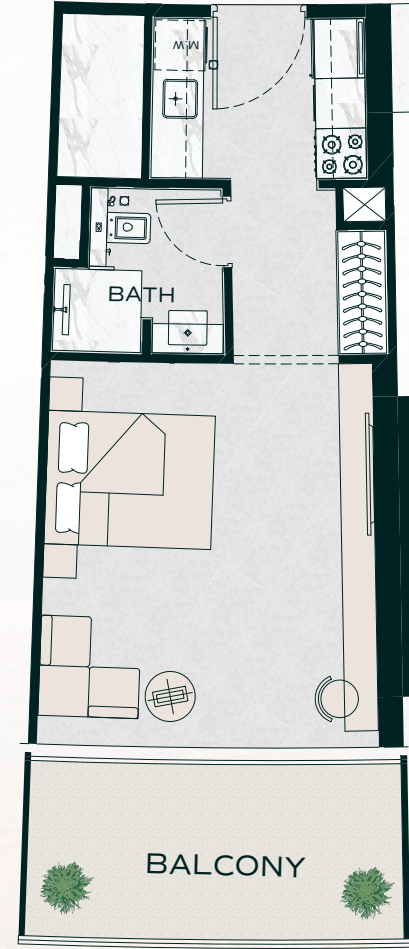
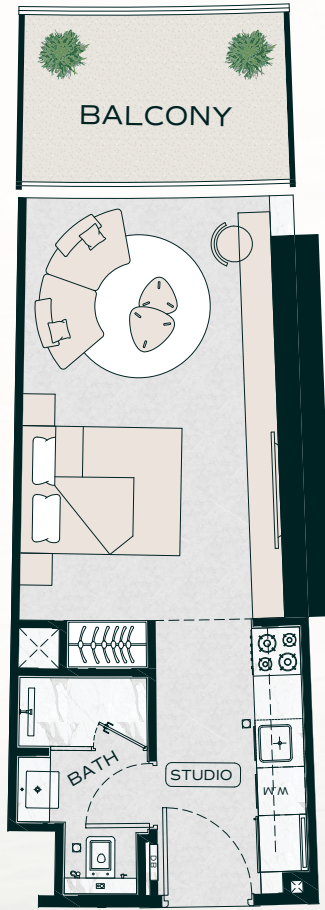

STUDIO TYPE -09

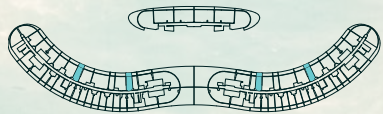

| AREA | SQ.M | SQ.FT |
|-----------------|----------------------|------------------------|
| AREA SUITE | 32.00 m ² | 344.45 ft ² |
| BALCONY AREA | 7.35 m ² | 79.11 ft ² |
| TOTAL UNIT AREA | 39.35 m ² | 423.56 ft ² |

FLAT DESIGN COMPONENTS

| | |
|---------|------------------|
| BATH | 4 m ² |
| STUDIO | 18 m |
| KITCHEN | 6 m ² |

STUDIO TYPE -10

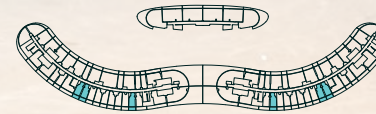

| AREA | SQ.M | SQ.FT |
|-----------------|----------------------|------------------------|
| AREA SUITE | 33.54 m ² | 361.02 ft ² |
| BALCONY AREA | 9.93 m ² | 106.89 ft ² |
| TOTAL UNIT AREA | 43.47 m ² | 467.91 ft ² |

FLAT DESIGN COMPONENTS

| | |
|---------|------------------|
| BATH | 4 m ² |
| STUDIO | 22 m |
| KITCHEN | 5 m ² |

UNIT TYPE - STUDIO

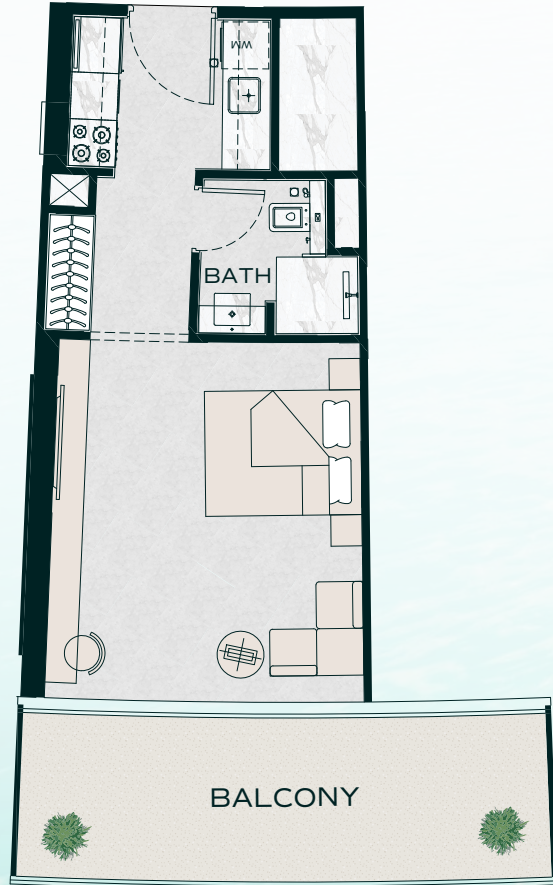

STUDIO TYPE -11

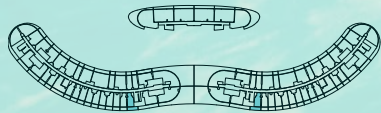

| AREA | SQ.M | SQ.FT | FLAT DESIGN COMPONENTS | |
|-----------------|----------------------|------------------------|------------------------|-------------------|
| AREA SUITE | 35.63 m ² | 383.52 ft ² | BATH | 4 m ² |
| BALCONY AREA | 15.49 m ² | 166.73 ft ² | STUDIO | 22 m ² |
| TOTAL UNIT AREA | 51.12 m ² | 550.25 ft ² | KITCHEN | 9 m ² |

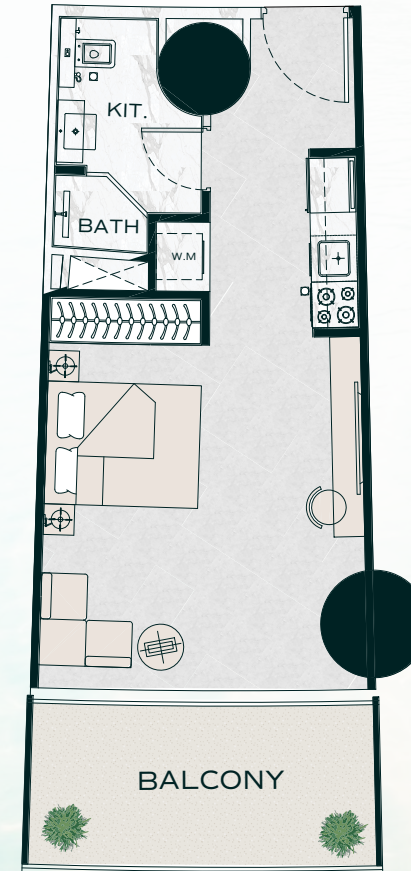

STUDIO TYPE -12

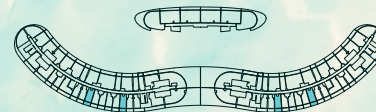

| AREA | SQ.M | SQ.FT | FLAT DESIGN COMPONENTS | |
|-----------------|----------------------|------------------------|------------------------|-------------------|
| AREA SUITE | 37.66 m ² | 405.37 ft ² | BATH | 4 m ² |
| BALCONY AREA | 9.93 m ² | 106.89 ft ² | STUDIO | 20 m ² |
| TOTAL UNIT AREA | 47.59 m ² | 512.25 ft ² | KITCHEN | 7m ² |
| | | | LAUNDRY | 1 m ² |

UNIT TYPE - STUDIO

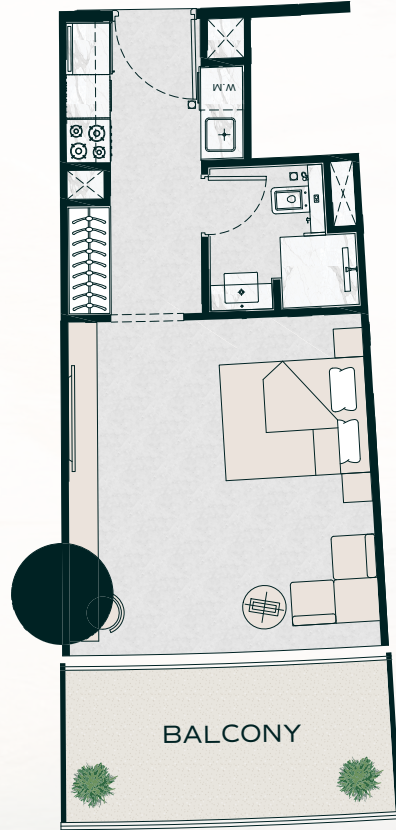

STUDIO TYPE -13

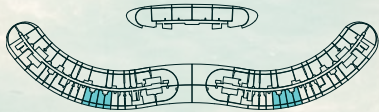

| AREA | SQ.M | SQ.FT |
|-----------------|----------------------|------------------------|
| AREA SUITE | 34.15 m ² | 367.59 ft ² |
| BALCONY AREA | 9.93 m ² | 106.89 ft ² |
| TOTAL UNIT AREA | 44.08 m ² | 474.47 ft ² |

FLAT DESIGN COMPONENTS

| | |
|---------|------------------|
| BATH | 4 m ² |
| STUDIO | 23 m |
| KITCHEN | 5 m ² |

Disclaimer: 1. All room dimensions are measured to structural elements and exclude wall finishes and construction tolerances. 2. All dimensions have been provided by our consultant architects. 3. All materials, dimensions and drawings are approximate. Information is subject to change without notice. 4. Actual suite area may vary from the stated area. Drawings not to scale. The developer reserves the right to make revisions. 5. Calculation of suite area is measured as the area bounded by the centre line of demising or partition walls separating one unit from another unit, the exterior face of all exterior walls, and the exterior face of the corridor wall enclosing the adjoining unit. 6. Calculation of balcony area is measured as the area bounded by the centre line of demising or partition walls separating one unit from another unit, the outmost face of the enclosing guard and the external face of the adjoining balcony. 7. The units are measured at typical floor in the building. Columns may vary in size depending on the floor level. 8. For each unit type, unit sizes and details might be slightly different. Please refer to the sales and purchase agreement for the actual size of each specific unit.

تنويه: ١. إن أبعاد الغرف يتم قياسها طبقاً للعناصر الهيكلية مع استبعاد تشطيبات الجدران ودرجة تحمل البناء. ٢. جميع القياسات تم تزويدها من قبل المهندسين المعماريين الاستشاريين لدينا. ٣. جميع المواد والأبعاد والرسومات تقريبية. تخضع المعلومات للتغيير دون إشعار مسبق. ٤. قد تختلف منطقة الجناح الفعلي عن المساحة المذكورة. الرسومات لا يتم توسيع نطاقها. يحتفظ المطور بالحق في إجراء التغييرات. ٥. يتم قياس حساب منطقة الجناح كمنطقة يحدها الخط المركزي للجدران الفاصلة أو الفاصلة التي تفصل وحدة عن وحدة أخرى، والوجه الخارجي لجميع الجدران الخارجية، والوجه الخارجي لجدار الممر المحيط بالوحدة المجاورة. ٦. ويقاس حساب منطقة الشرفة على أنها المنطقة التي يحدها الخط المركزي للجدران الفاصلة أو الفاصلة التي تفصل وحدة عن وحدة أخرى، والوجه الأبعد للحارس المرفق والوجه الخارجي للشرفة المجاورة. ٧. يتم قياس الوحدات في الطابق النموذجي في المبنى. قد تختلف الأعمدة في الحجم حسب مستوى الطابق. ٨. قد تكون أحجام الوحدات والتفاصيل المتعلقة بها مختلفة وذلك حسب نوع الوحدة. يرجى الرجوع إلى اتفاقية البيع والشراء لمعرفة الحجم الفعلي لكل وحدة.

UNIT TYPE - 1 BEDROOM

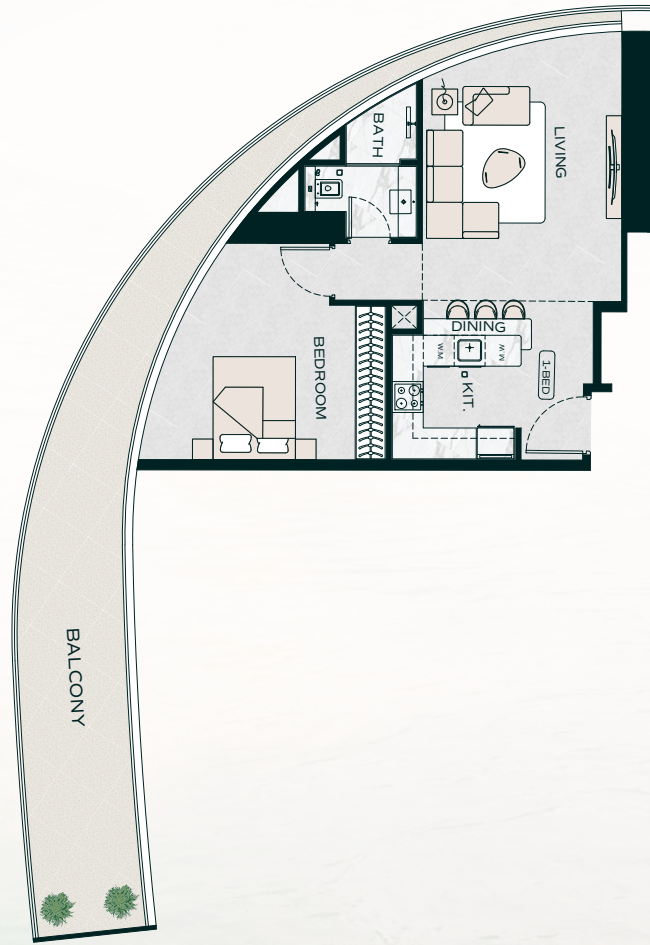

1-BEDROOM TYPE -01

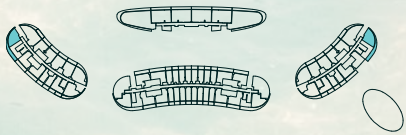

FLAT DESIGN COMPONENTS

| AREA | SQ.M | SQ.FT | M.BATH | 4 m ² |
|-----------------|----------------------|-------------------------|------------------|-------------------|
| AREA SUITE | 59.70 m ² | 642.61 ft ² | M.BEDROOM | 16 m |
| BALCONY AREA | 35.24 m ² | 379.32 ft ² | LIVING | 19 m ² |
| TOTAL UNIT AREA | 94.94 m ² | 1021.93 ft ² | KITCHEN & DINING | 12 m ² |

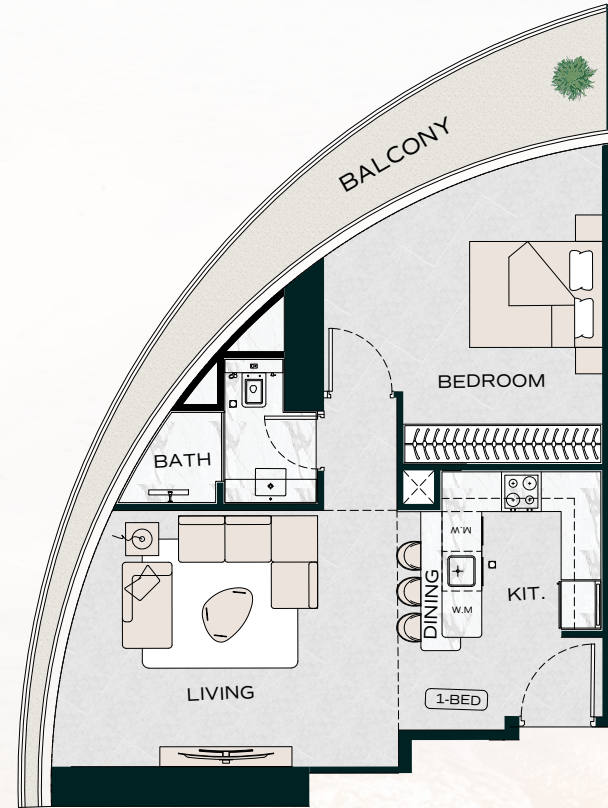

1-BEDROOM TYPE -02

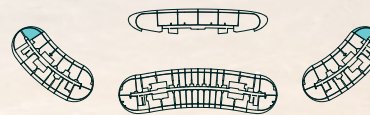

FLAT DESIGN COMPONENTS

| AREA | SQ.M | SQ.FT | M.BATH | 4 m ² |
|-----------------|----------------------|------------------------|------------------|-------------------|
| AREA SUITE | 59.42 m ² | 639.59 ft ² | M.BEDROOM | 16 m |
| BALCONY AREA | 13.38 m ² | 144.02 ft ² | LIVING | 19 m ² |
| TOTAL UNIT AREA | 72.80 m ² | 783.61 ft ² | KITCHEN & DINING | 12 m ² |

UNIT TYPE - 1 BEDROOM

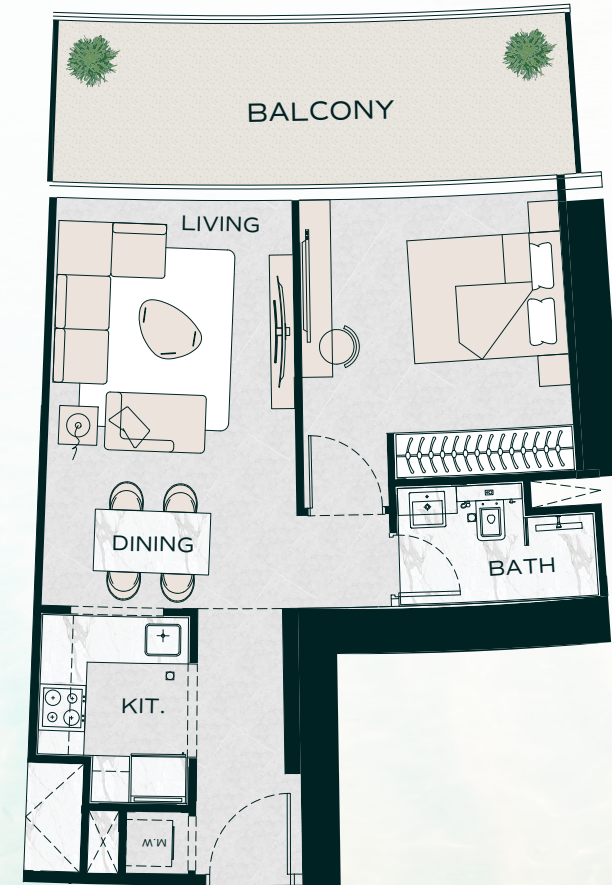
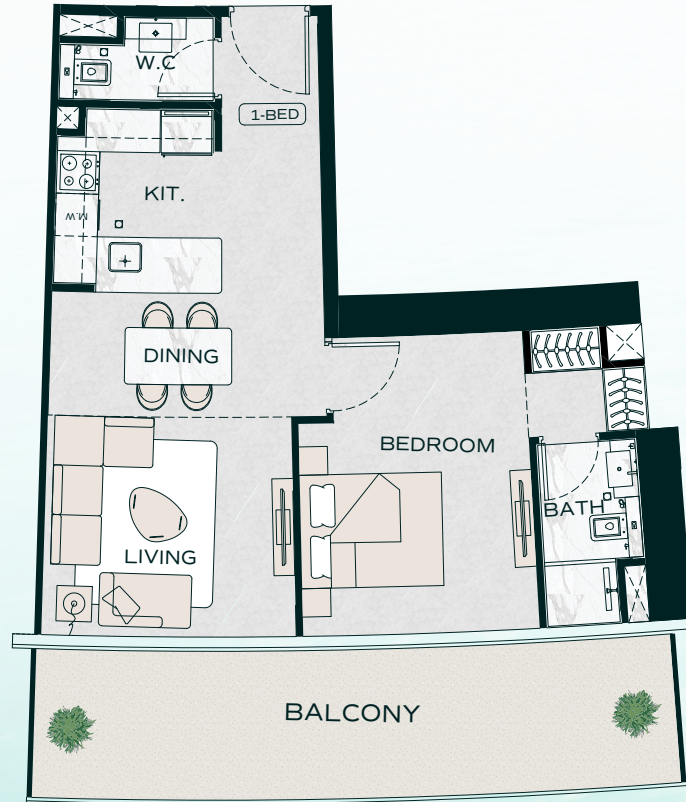

1-BEDROOM TYPE -03

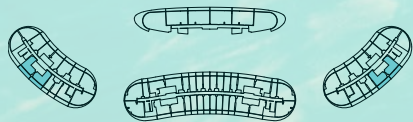

FLAT DESIGN COMPONENTS

| AREA | SQ.M | SQ.FT | | |
|-----------------|----------------------|------------------------|------------------|-------------------|
| | | | M.BATH | 4 m ² |
| AREA SUITE | 59.42 m ² | 639.59 ft ² | M.BEDROOM | 16 m |
| BALCONY AREA | 13.38 m ² | 144.02 ft ² | LIVING | 19 m ² |
| TOTAL UNIT AREA | 72.80 m ² | 783.61 ft ² | KITCHEN & DINING | 12 m ² |

1-BEDROOM TYPE -04

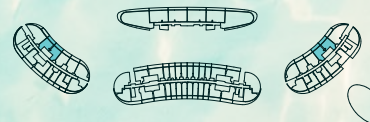

FLAT DESIGN COMPONENTS

| AREA | SQ.M | SQ.FT | | |
|-----------------|----------------------|------------------------|-----------------|-------------------|
| | | | M.BATH | 4 m ² |
| AREA SUITE | 51.62 m ² | 555.63 ft ² | M.BEDROOM | 13 m |
| BALCONY AREA | 14.69 m ² | 158.12 ft ² | LIVING & DINING | 17 m ² |
| TOTAL UNIT AREA | 66.31 m ² | 713.75 ft ² | KITCHEN | 5 m ² |
| | | | LAUNDRY | 1 m ² |
| | | | CORRIDOR | 4 m ² |

UNIT TYPE - 1 BEDROOM

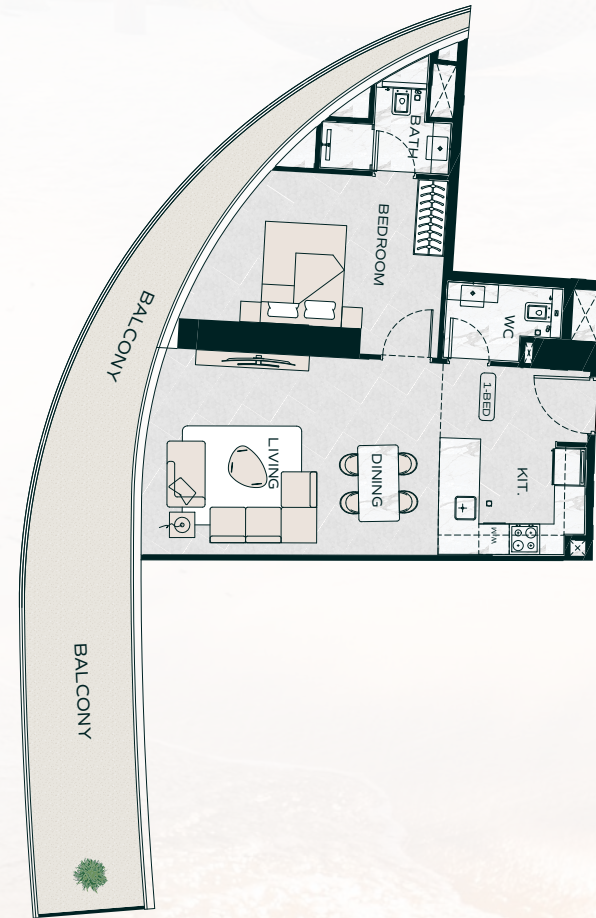
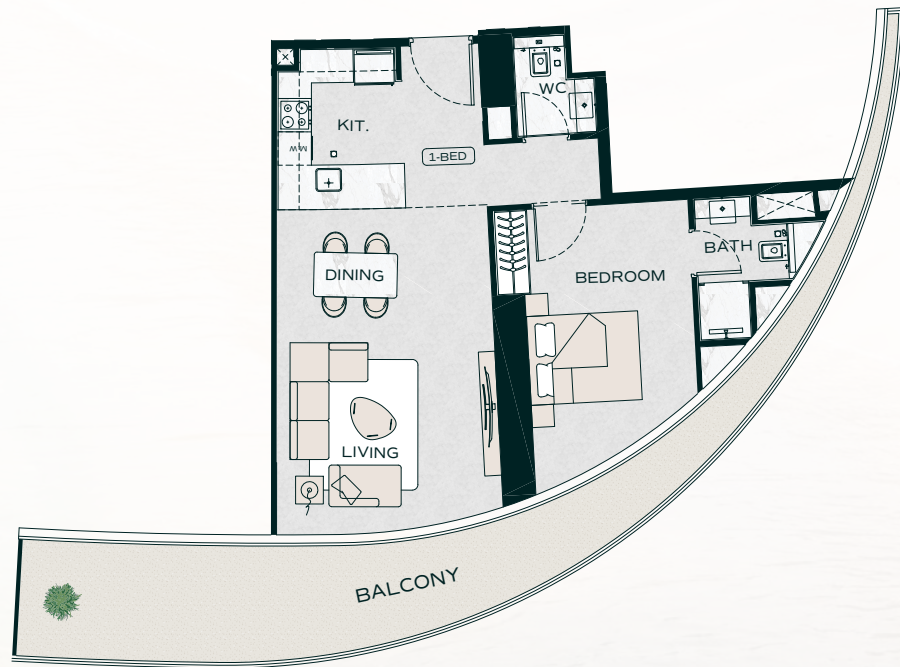

1-BEDROOM TYPE -05

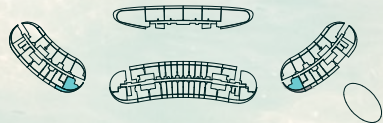

FLAT DESIGN COMPONENTS

| AREA | SQ.M | SQ.FT |
|-----------------|----------------------|------------------------|
| AREA SUITE | 63.79 m ² | 686.63 ft ² |
| BALCONY AREA | 15.82 m ² | 170.29 ft ² |
| TOTAL UNIT AREA | 79.61 m ² | 856.91 ft ² |

| | |
|-----------------|-------------------|
| M.BATH | 4 m ² |
| M.BEDROOM | 14 m ² |
| LIVING & DINING | 22 m ² |
| KITCHEN | 6 m ² |
| WC | 2 m ² |
| CORRIDOR | 7 m ² |

1-BEDROOM TYPE -06

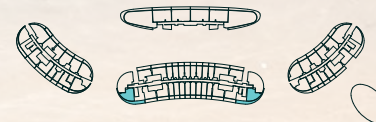

FLAT DESIGN COMPONENTS

| AREA | SQ.M | SQ.FT |
|-----------------|----------------------|-------------------------|
| AREA SUITE | 62.22 m ² | 669.73 ft ² |
| BALCONY AREA | 32.74 m ² | 352.41 ft ² |
| TOTAL UNIT AREA | 94.96 m ² | 1022.14 ft ² |

| | |
|-----------------|-------------------|
| M.BATH | 4 m ² |
| M.BEDROOM | 16 m ² |
| LIVING & DINING | 23 m ² |
| KITCHEN | 11 m ² |
| WC | 3 m ² |

UNIT TYPE - 1 BEDROOM

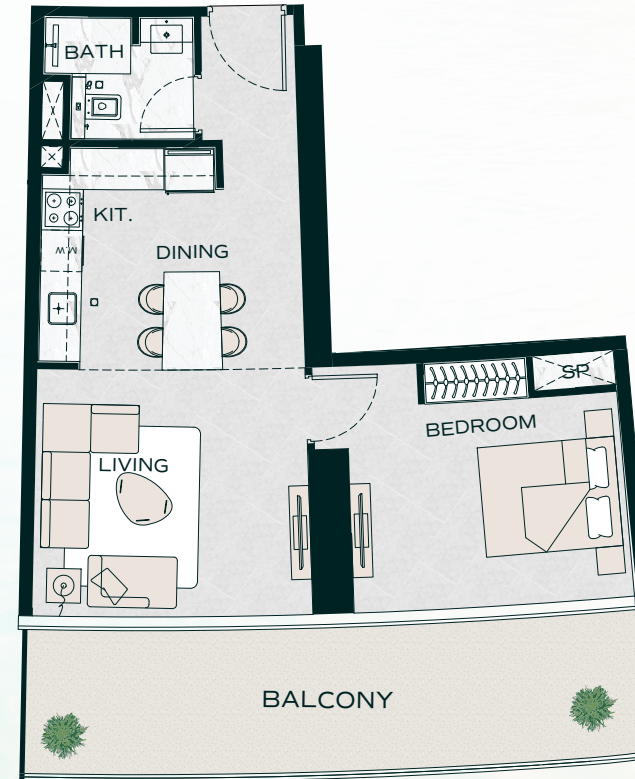
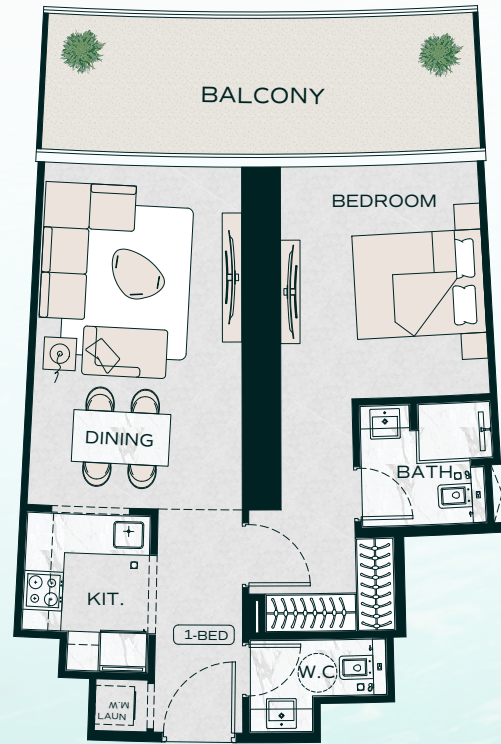

1-BEDROOM TYPE -07

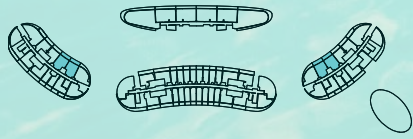

FLAT DESIGN COMPONENTS

| | |
|-----------------|-------------------|
| M.BATH | 4 m ² |
| M.BEDROOM | 17 m |
| LIVING & DINING | 17 m ² |
| KITCHEN | 5 m ² |
| WC | 3 m ² |
| LAUNDRY | 5 m ² |
| CORRIDOR | 1 m ² |

| AREA | SQ.M | SQ.FT |
|-----------------|----------------------|------------------------|
| AREA SUITE | 58.20 m ² | 626.46 ft ² |
| BALCONY AREA | 14.69 m ² | 158.12 ft ² |
| TOTAL UNIT AREA | 72.89 m ² | 784.58 ft ² |

1-BEDROOM TYPE -08

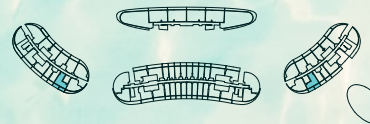

FLAT DESIGN COMPONENTS

| | |
|-----------------|-------------------|
| M.BATH | 4 m ² |
| M.BEDROOM | 15 m |
| LIVING & DINING | 18 m ² |
| KITCHEN | 6 m ² |
| WC | 2 m ² |
| CORRIDOR | 6 m ² |

| AREA | SQ.M | SQ.FT |
|-----------------|----------------------|------------------------|
| AREA SUITE | 53.46 m ² | 575.44 ft ² |
| BALCONY AREA | 19.85 m ² | 213.66 ft ² |
| TOTAL UNIT AREA | 73.31 m ² | 789.10 ft ² |

UNIT TYPE - 1 BEDROOM

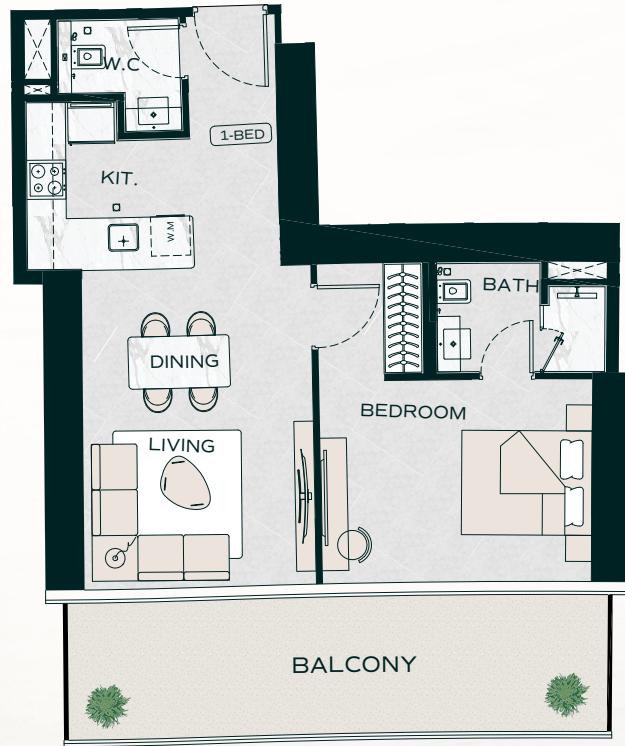

1-BEDROOM TYPE -09

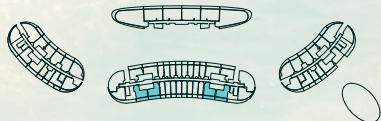

FLAT DESIGN COMPONENTS

| AREA | SQ.M | SQ.FT | | |
|-----------------|----------------------|------------------------|-----------------|-------------------|
| | | | M.BATH | 4 m ² |
| | | | M.BEDROOM | 16 m |
| | | | LIVING & DINING | 17 m ² |
| | | | KITCHEN | 9 m ² |
| | | | WC | 3 m ² |
| | | | CORRIDOR | 3 m ² |
| AREA SUITE | 59.45 m ² | 639.91 ft ² | | |
| BALCONY AREA | 18.15 m ² | 195.36 ft ² | | |
| TOTAL UNIT AREA | 77.60 m ² | 835.28 ft ² | | |

1-BEDROOM TYPE -10

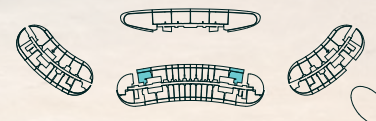

FLAT DESIGN COMPONENTS

| AREA | SQ.M | SQ.FT | | |
|-----------------|----------------------|------------------------|-----------------|-------------------|
| | | | M.BATH | 4 m ² |
| | | | M.BEDROOM | 17 m |
| | | | LIVING & DINING | 13 m ² |
| | | | KITCHEN | 14 m ² |
| | | | WC | 2 m ² |
| | | | CORRIDOR | 4 m ² |
| AREA SUITE | 60.42 m ² | 650.36 ft ² | | |
| BALCONY AREA | 20.93 m ² | 225.29 ft ² | | |
| TOTAL UNIT AREA | 81.35 m ² | 875.64 ft ² | | |

UNIT TYPE - 1 BEDROOM

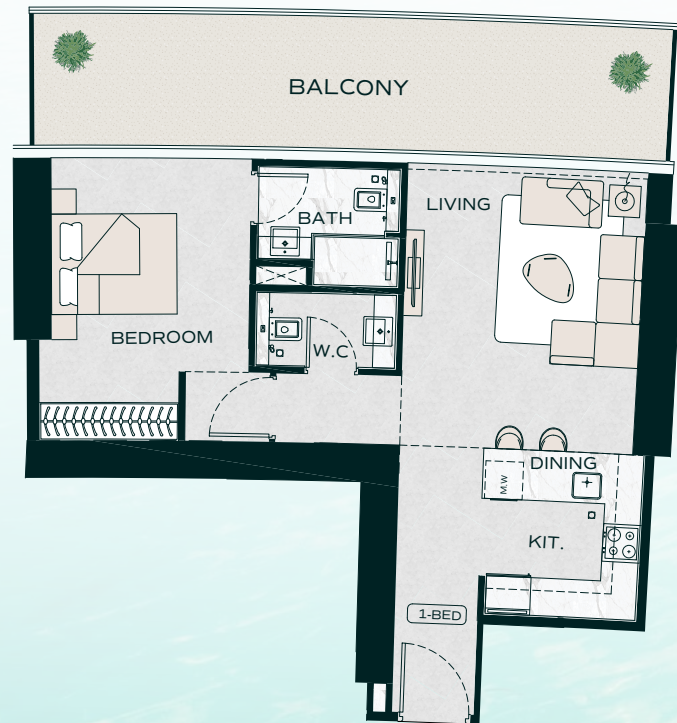

1-BEDROOM TYPE -11

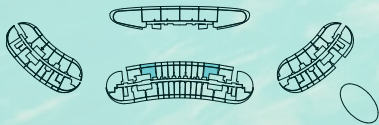

FLAT DESIGN COMPONENTS

| AREA | SQ.M | SQ.FT |
|-----------------|----------------------|------------------------|
| AREA SUITE | 26.16 m ² | 663.27 ft ² |
| BALCONY AREA | 22.71 m ² | 244.45 ft ² |
| TOTAL UNIT AREA | 84.33 m ² | 907.72 ft ² |

| | |
|-----------------|-------------------|
| M.BATH | 4 m ² |
| M.BEDROOM | 15 m ² |
| LIVING & DINING | 19 m ² |
| KITCHEN | 9 m ² |
| WC | 3 m ² |
| CORRIDOR | 3 m ² |

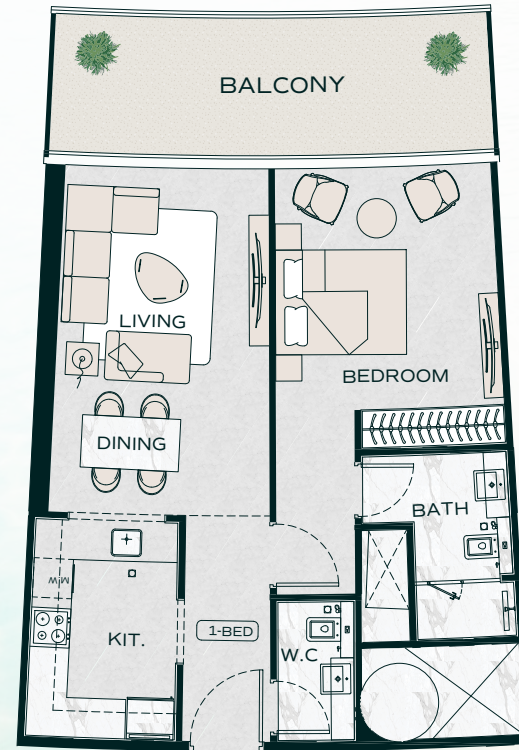

1-BEDROOM TYPE -12

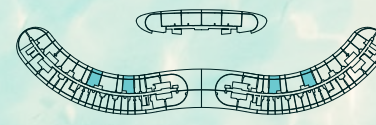

FLAT DESIGN COMPONENTS

| AREA | SQ.M | SQ.FT |
|-----------------|----------------------|------------------------|
| AREA SUITE | 60.81 m ² | 654.55 ft ² |
| BALCONY AREA | 14.69 m ² | 158.12 ft ² |
| TOTAL UNIT AREA | 75.50 m ² | 812.68 ft ² |

| | |
|-----------------|-------------------|
| M.BATH | 5 m ² |
| M.BEDROOM | 17 m ² |
| LIVING & DINING | 17 m ² |
| KITCHEN | 8 m ² |
| WC | 3 m ² |
| CORRIDOR | 5 m ² |

UNIT TYPE - 1 BEDROOM

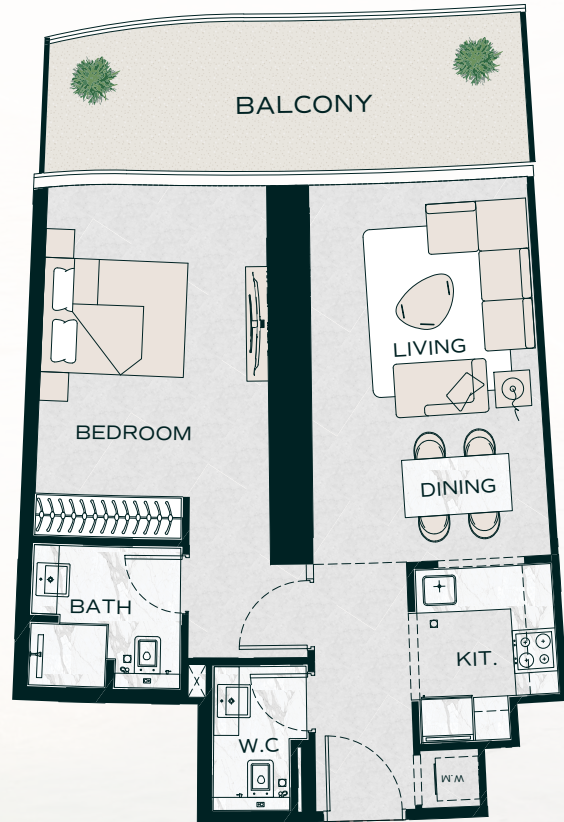

Disclaimer: 1. All room dimensions are measured to structural elements and exclude wall finishes and construction tolerances. 2. All dimensions have been provided by our consultant architects. 3. All materials, dimensions and drawings are approximate. Information is subject to change without notice. 4. Actual suite area may vary from the stated area. Drawings not to scale. The developer reserves the right to make revisions. 5. Calculation of suite area is measured as the area bounded by the centre line of demising or partition walls separating one unit from another unit, the exterior face of all exterior walls, and the exterior face of the corridor wall enclosing the adjoining unit. 6. Calculation of balcony area is measured as the area bounded by the centre line of demising or partition walls separating one unit from another unit, the outmost face of the enclosing guard and the external face of the adjoining balcony. 7. The units are measured at typical floor in the building. Columns may vary in size depending on the floor level. 8. For each unit type, unit sizes and details might be slightly different. Please refer to the sales and purchase agreement for the actual size of each specific unit.

1-BEDROOM TYPE -13

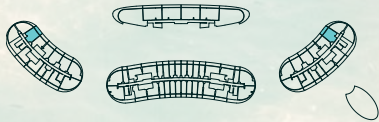

FLAT DESIGN COMPONENTS

| | |
|-----------------|-------------------|
| M.BATH | 4 m ² |
| M.BEDROOM | 18 m |
| LIVING & DINING | 17 m ² |
| KITCHEN | 5 m ² |
| WC | 3 m ² |
| CORRIDOR | 5 m ² |
| LAUNDRY | 1 m ² |

| AREA | SQ.M | SQ.FT |
|-----------------|----------------------|------------------------|
| AREA SUITE | 59.96 m ² | 645.40 ft ² |
| BALCONY AREA | 14.38 m ² | 154.79 ft ² |
| TOTAL UNIT AREA | 74.34 m ² | 800.19 ft ² |

تنويه: ١. إن أبعاد الغرف يتم قياسها طبقاً للعناصر الهيكلية مع استبعاد تشطيبات الجدران ودرجة تحمل البناء. ٢. جميع القياسات تم تزويدها من قبل المهندسين المعماريين الاستشاريين لدينا. ٣. جميع المواد والأبعاد والرسومات تقريبية. تخضع المعلومات للتغيير دون إشعار مسبق. ٤. قد تختلف منطقة الجناح الفعلي عن المساحة المذكورة. الرسومات لا يتم توسيع نطاقها. يحتفظ المطور بالحق في إجراء التغييرات. ٥. يتم قياس حساب منطقة الجناح كمنطقة يحدها الخط المركزي للجدران الفاصلة أو الفاصلة التي تفصل وحدة عن وحدة أخرى، والوجه الخارجي لجميع الجدران الخارجية، والوجه الخارجي لحدار الممر المحيط بالوحدة المجاورة. ٦. ويقاس حساب منطقة الشرفة على أنها المنطقة التي يحدها الخط المركزي للجدران الفاصلة أو الفاصلة التي تفصل وحدة عن وحدة أخرى. والوجه الأبعد للحارس المرفق والوجه الخارجي للشرفة المجاورة. ٧. يتم قياس الوحدات في الطابق النموذجي في المبنى. قد تختلف الأعمدة في الحجم حسب مستوى الطابق. ٨. قد تكون أحجام الوحدات والتفاصيل المتعلقة بها مختلفة وذلك حسب نوع الوحدة. يرجى الرجوع إلى اتفاقية البيع والشراء لمعرفة الحجم الفعلي لكل وحدة.

UNIT TYPE - 2 BEDROOM

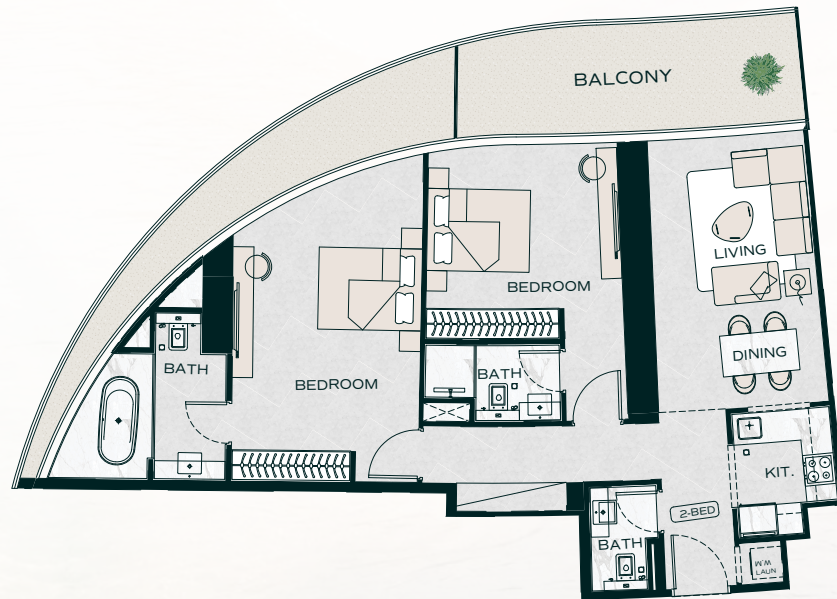

2 BEDROOM TYPE -01

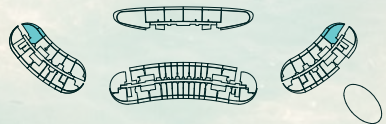

FLAT DESIGN COMPONENTS

| | |
|-----------------|-------------------|
| M.BATH | 8 m ² |
| M.BEDROOM | 21 m ² |
| LIVING & DINING | 17 m ² |
| KITCHEN | 5 m ² |
| BATH | 4 m ² |
| CORRIDOR | 11 m ² |
| BEDROOM | 16 m ² |
| WC | 3 m ² |
| LAUNDRY | 6 m ² |

| AREA | SQ.M | SQ.FT |
|-----------------|-----------------------|-------------------------|
| AREA SUITE | 96.16 m ² | 1035.06 ft ² |
| BALCONY AREA | 26.81 m ² | 288.58 ft ² |
| TOTAL UNIT AREA | 122.97 m ² | 1323.64 ft ² |

2 BEDROOM TYPE -02

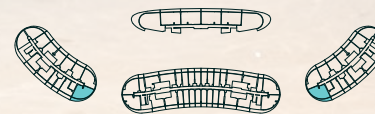

FLAT DESIGN COMPONENTS

| | |
|-----------------|-------------------|
| M.BATH | 4 m ² |
| M.BEDROOM | 14 m ² |
| LIVING & DINING | 22 m ² |
| KITCHEN | 10 m ² |
| BATH | 4 m ² |
| CORRIDOR | 3 m ² |
| BEDROOM | 18 m ² |

| AREA | SQ.M | SQ.FT |
|-----------------|-----------------------|-------------------------|
| AREA SUITE | 84.00 m ² | 904.17 ft ² |
| BALCONY AREA | 17.23 m ² | 185.46 ft ² |
| TOTAL UNIT AREA | 101.23 m ² | 1089.63 ft ² |

UNIT TYPE - 2 BEDROOM

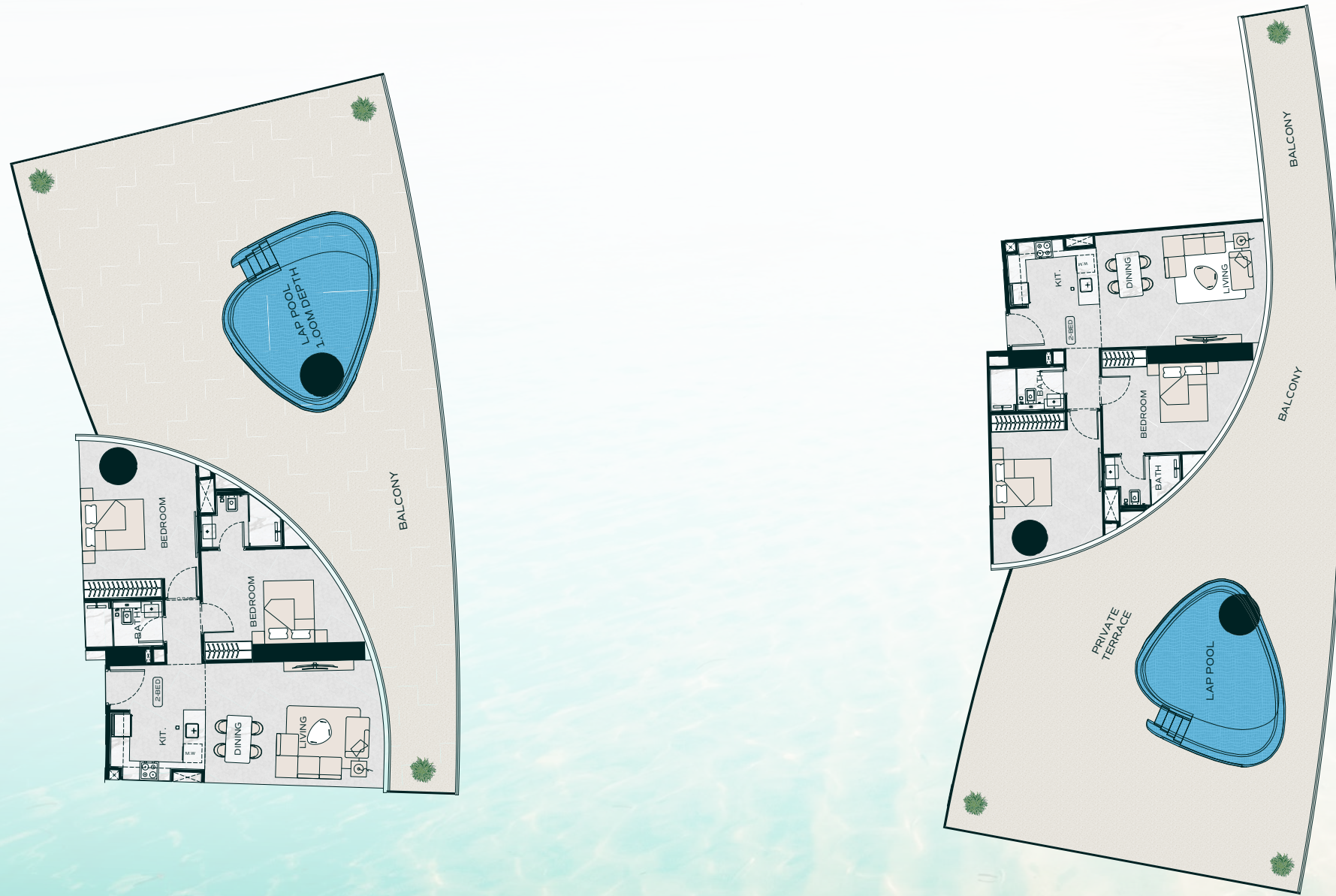

2 BEDROOM TYPE -03



| AREA | SQ.M | SQ.FT |
|-----------------|-----------------------|-------------------------|
| AREA SUITE | 84.07 m ² | 904.92 ft ² |
| BALCONY AREA | 166.07 m ² | 1787.56 ft ² |
| TOTAL UNIT AREA | 250.14 m ² | 2692.48 ft ² |

FLAT DESIGN COMPONENTS

| | |
|-----------------|-------------------|
| M.BATH | 4 m ² |
| M.BEDROOM | 14 m ² |
| LIVING & DINING | 22 m ² |
| KITCHEN | 10 m ² |
| BATH | 4 m ² |
| CORRIDOR | 3 m ² |
| BEDROOM | 18 m ² |

2 BEDROOM TYPE -04



| AREA | SQ.M | SQ.FT |
|-----------------|-----------------------|-------------------------|
| AREA SUITE | 84.45 m ² | 909.01 ft ² |
| BALCONY AREA | 183.01 m ² | 1969.90 ft ² |
| TOTAL UNIT AREA | 267.46 m ² | 2878.92 ft ² |

FLAT DESIGN COMPONENTS

| | |
|-----------------|-------------------|
| M.BATH | 4 m ² |
| M.BEDROOM | 14 m ² |
| LIVING & DINING | 22 m ² |
| KITCHEN | 10 m ² |
| BATH | 4 m ² |
| CORRIDOR | 3 m ² |
| BEDROOM | 18 m ² |

UNIT TYPE - 2 BEDROOM

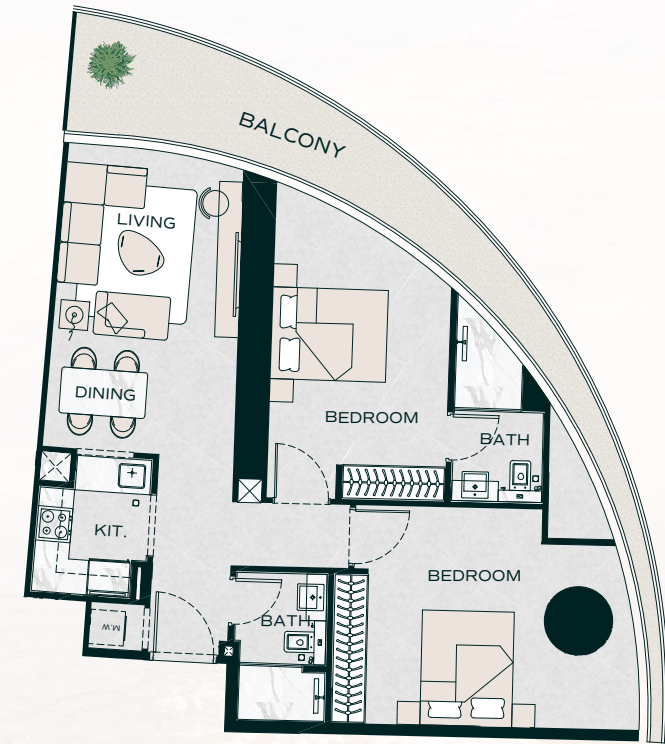
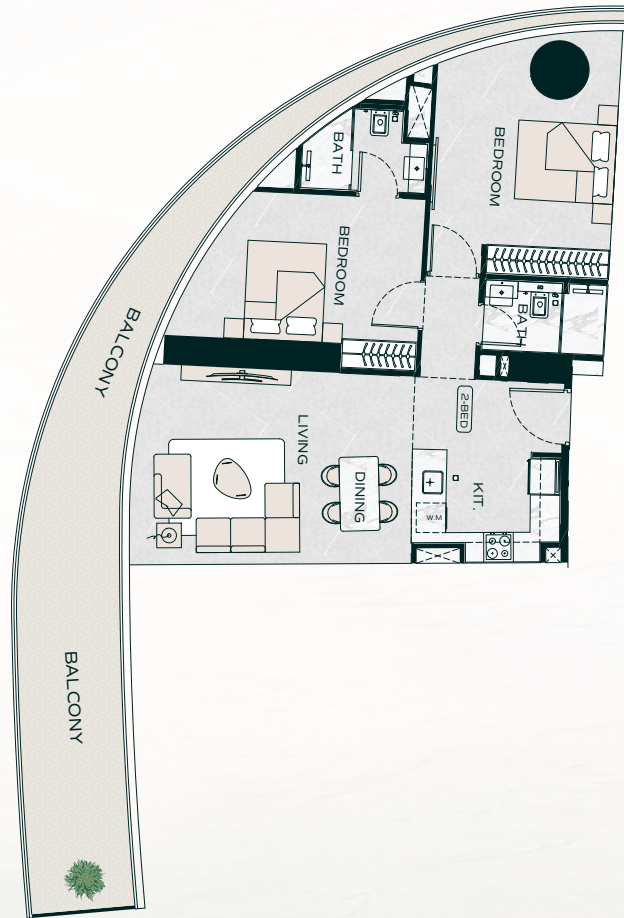

2 BEDROOM TYPE -05

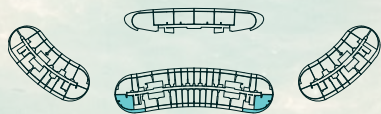

| AREA | SQ.M | SQ.FT |
|-----------------|-----------------------|-------------------------|
| AREA SUITE | 84.39 m ² | 908.37 ft ² |
| BALCONY AREA | 34.17 m ² | 367.80 ft ² |
| TOTAL UNIT AREA | 118.56 m ² | 1276.17 ft ² |

FLAT DESIGN COMPONENTS

| | |
|-----------------|-------------------|
| M.BATH | 4 m ² |
| M.BEDROOM | 14 m |
| LIVING & DINING | 22 m ² |
| KITCHEN | 10 m ² |
| BATH | 4 m ² |
| CORRIDOR | 3 m ² |
| BEDROOM | 18 m ² |

2 BEDROOM TYPE -06

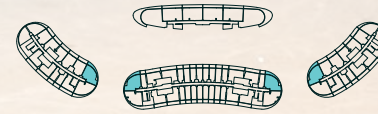

| AREA | SQ.M | SQ.FT |
|-----------------|----------------------|-------------------------|
| AREA SUITE | 80.39 m ² | 865.31 ft ² |
| BALCONY AREA | 16.95 m ² | 182.45 ft ² |
| TOTAL UNIT AREA | 97.34 m ² | 1047.76 ft ² |

FLAT DESIGN COMPONENTS

| | |
|-----------------|-------------------|
| M.BATH | 4 m ² |
| M.BEDROOM | 14 m |
| LIVING & DINING | 22 m ² |
| KITCHEN | 10 m ² |
| BATH | 4 m ² |
| CORRIDOR | 3 m ² |
| BEDROOM | 18 m ² |
| LAUNDRY | 1 m ² |

UNIT TYPE - 2 BEDROOM

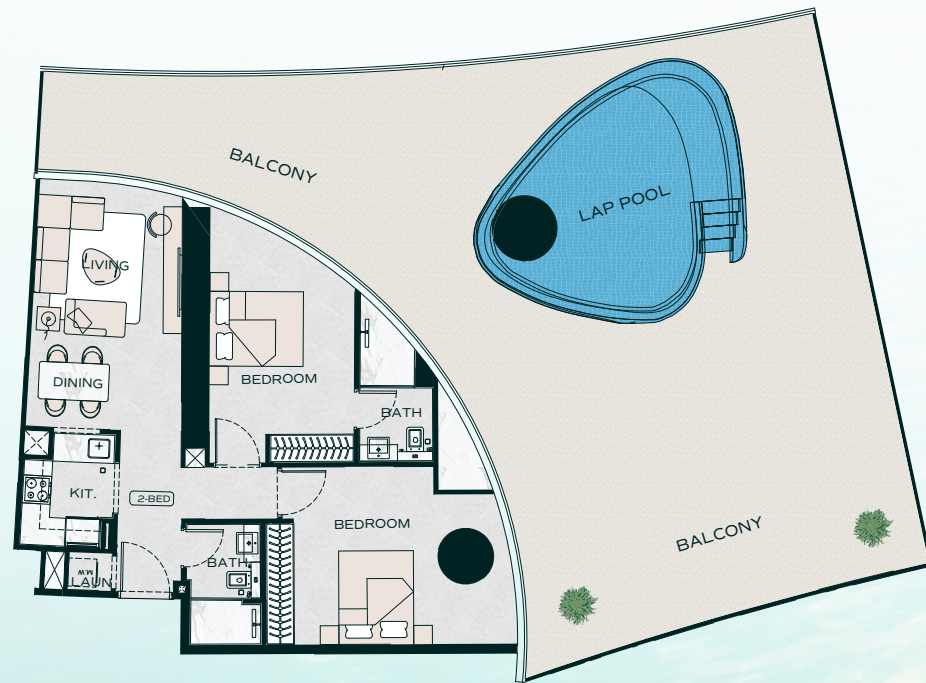

2 BEDROOM TYPE -07



FLAT DESIGN COMPONENTS

| | |
|-----------------|-------------------|
| M.BATH | 4 m ² |
| M.BEDROOM | 14 m ² |
| LIVING & DINING | 22 m ² |
| KITCHEN | 10 m ² |
| BATH | 4 m ² |
| CORRIDOR | 3 m ² |
| BEDROOM | 18 m ² |
| LAUNDRY | 1 m ² |

| AREA | SQ.M | SQ.FT |
|-----------------|-----------------------|-------------------------|
| AREA SUITE | 80.39 m ² | 865.31 ft ² |
| BALCONY AREA | 138.43 m ² | 1490.05 ft ² |
| TOTAL UNIT AREA | 218.82 m ² | 2355.36 ft ² |

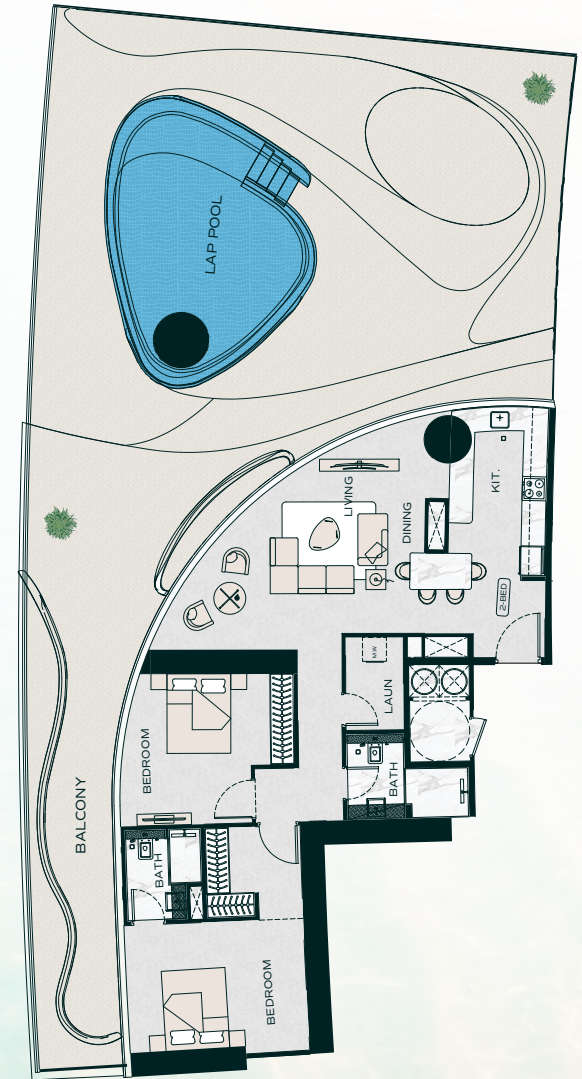

2 BEDROOM TYPE -08

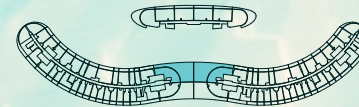

FLAT DESIGN COMPONENTS

| | |
|-----------------|-------------------|
| M.BATH | 4 m ² |
| M.BEDROOM | 14 m ² |
| LIVING & DINING | 24 m ² |
| KITCHEN | 20 m ² |
| BATH | 5 m ² |
| CORRIDOR | 6 m ² |
| BEDROOM | 15 m ² |
| LAUNDRY | 4 m ² |

| AREA | SQ.M | SQ.FT |
|-----------------|-----------------------|-------------------------|
| AREA SUITE | 110.46 m ² | 1188.98 ft ² |
| BALCONY AREA | 180.14 m ² | 1939.01 ft ² |
| TOTAL UNIT AREA | 290.60 m ² | 3127.99 ft ² |

UNIT TYPE - 2 BEDROOM

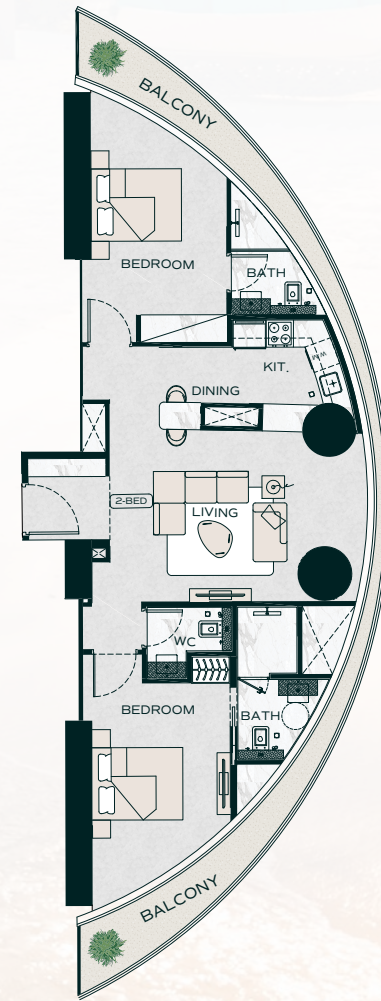
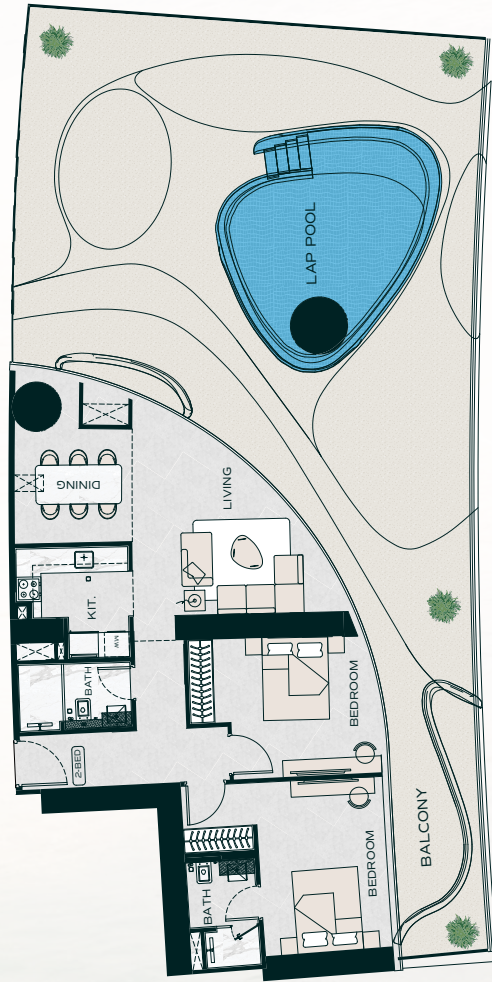

2 BEDROOM TYPE -09

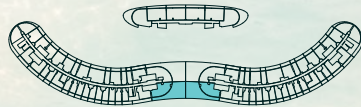

| AREA | SQ.M | SQ.FT |
|-----------------|-----------------------|-------------------------|
| AREA SUITE | 93.98 m ² | 1011.59 ft ² |
| BALCONY AREA | 143.78 m ² | 1547.64 ft ² |
| TOTAL UNIT AREA | 237.76 m ² | 2559.23 ft ² |

FLAT DESIGN COMPONENTS

| | |
|-----------------|-------------------|
| M.BATH | 4 m ² |
| M.BEDROOM | 14 m ² |
| LIVING & DINING | 24 m ² |
| KITCHEN | 20 m ² |
| BATH | 5 m ² |
| CORRIDOR | 6 m ² |
| BEDROOM | 15 m ² |

2 BEDROOM TYPE -10

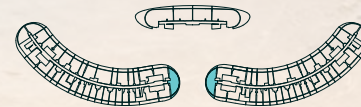

| AREA | SQ.M | SQ.FT |
|-----------------|-----------------------|-------------------------|
| AREA SUITE | 88.51 m ² | 952.71 ft ² |
| BALCONY AREA | 17.51 m ² | 188.48 ft ² |
| TOTAL UNIT AREA | 106.02 m ² | 1141.19 ft ² |

FLAT DESIGN COMPONENTS

| | |
|------------------|-------------------|
| M.BATH | 5 m ² |
| M.BEDROOM | 14 m ² |
| LIVING | 18 m ² |
| KITCHEN & DINING | 12 m ² |
| BATH | 4 m ² |
| CORRIDOR | 9 m ² |
| BEDROOM | 15 m ² |
| WC | 2 m ² |

UNIT TYPE - 2 BEDROOM

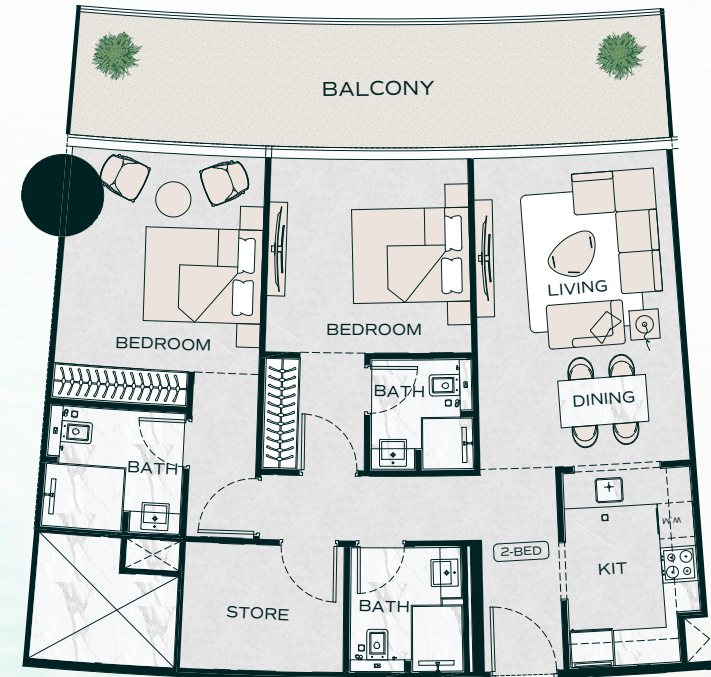
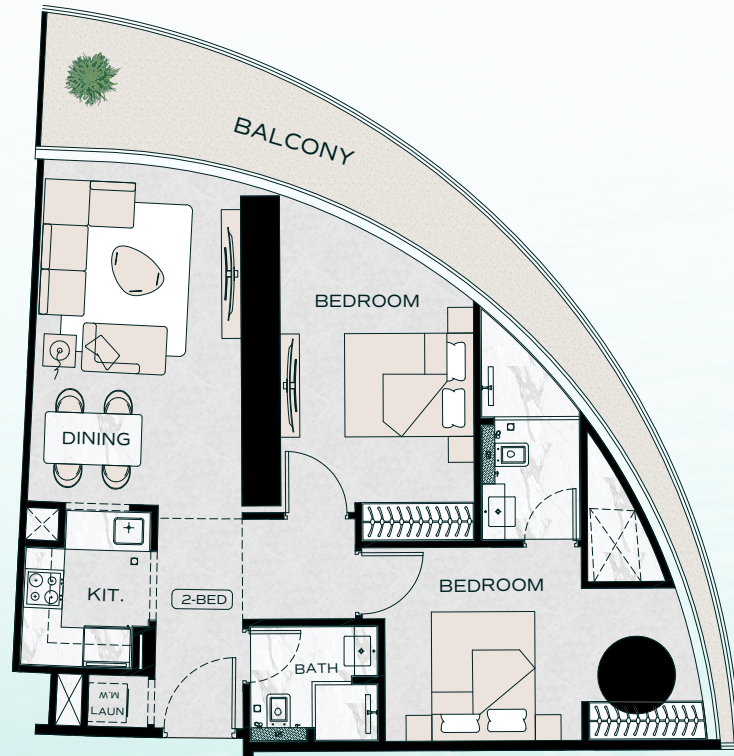

2 BEDROOM TYPE -11

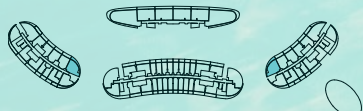

FLAT DESIGN COMPONENTS

| | |
|-----------------|-------------------|
| M.BATH | 4 m ² |
| M.BEDROOM | 14 m |
| LIVING & DINING | 22 m ² |
| KITCHEN | 10 m ² |
| BATH | 4 m ² |
| CORRIDOR | 3 m ² |
| BEDROOM | 18 m ² |
| LAUNDRY | 1 m ² |

| AREA | SQ.M | SQ.FT |
|-----------------|----------------------|------------------------|
| AREA SUITE | 73.57 m ² | 791.90 ft ² |
| BALCONY AREA | 17.42 m ² | 187.51 ft ² |
| TOTAL UNIT AREA | 90.99 m ² | 979.41 ft ² |

2 BEDROOM TYPE -12

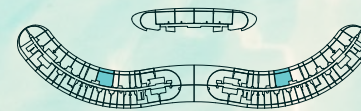

FLAT DESIGN COMPONENTS

| | |
|-----------------|-------------------|
| M.BATH | 5 m ² |
| M.BEDROOM | 17 m |
| LIVING & DINING | 18 m ² |
| KITCHEN | 7 m ² |
| BATH | 4 m ² |
| CORRIDOR | 9 m ² |
| BEDROOM | 15 m ² |
| STORE | 16 m ² |
| BATH | 4 m ² |

| AREA | SQ.M | SQ.FT |
|-----------------|----------------------|------------------------|
| AREA SUITE | 63.79 m ² | 686.63 ft ² |
| BALCONY AREA | 15.82 m ² | 170.29 ft ² |
| TOTAL UNIT AREA | 79.61 m ² | 856.91 ft ² |

UNIT TYPE - 2 BEDROOM • ISLAND

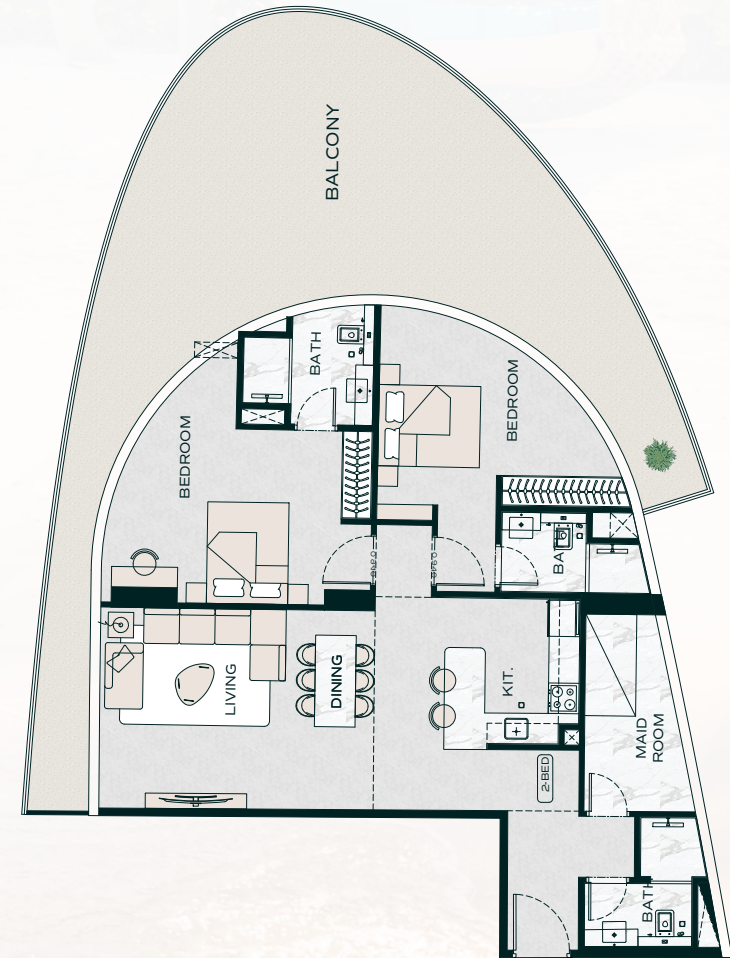
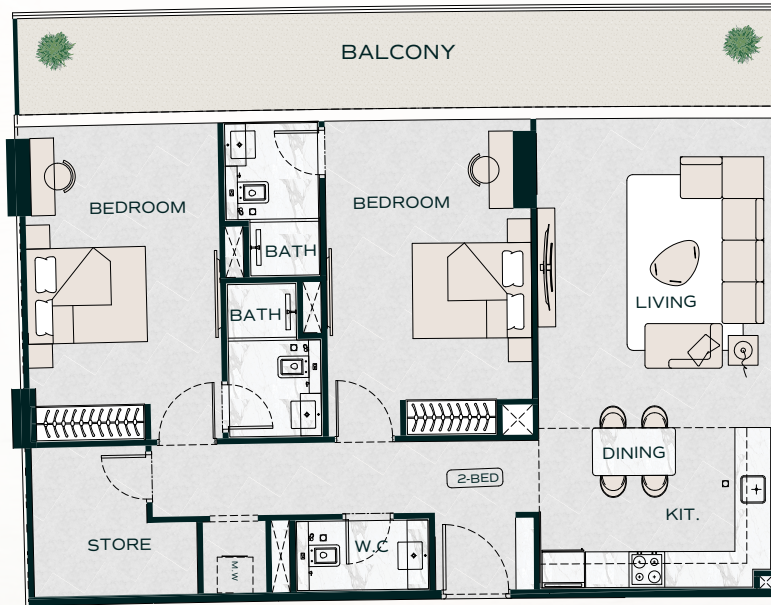

2 BEDROOM TYPE 01

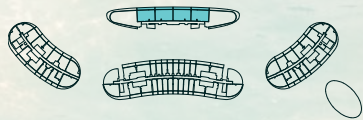

| AREA | SQ.M | SQ.FT |
|-----------------|-----------------------|------------------------|
| AREA SUITE | 100.64 m ² | 1083.28ft ² |
| BALCONY AREA | 22.59 m ² | 243.16 ft ² |
| TOTAL UNIT AREA | 123.23 m ² | 1326.44ft ² |

FLAT DESIGN COMPONENTS

| | |
|------------------|-------------------|
| M.BATH | 4 m ² |
| M.BEDROOM | 17 m ² |
| LIVING | 20 m ² |
| KITCHEN & DINING | 10 m ² |
| BATH | 4 m ² |
| CORRRIDOR | 10 m ² |
| BEDROOM | 16 m ² |
| STORE | 6 m ² |
| LAUNDRY | 1 m ² |
| WC | 3 m ² |

2 BEDROOM TYPE 02

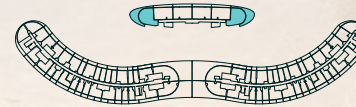

| AREA | SQ.M | SQ.FT |
|-----------------|-----------------------|-------------------------|
| AREA SUITE | 109.44 m ² | 1178.00 ft ² |
| BALCONY AREA | 66.07 m ² | 711.17 ft ² |
| TOTAL UNIT AREA | 175.51 m ² | 1889.17 ft ² |

FLAT DESIGN COMPONENTS

| | |
|-----------------|-------------------|
| M.BATH | 5 m ² |
| M.BEDROOM | 19 m ² |
| LIVING & DINING | 21 m ² |
| KITCHEN | 13 m ² |
| BATH | 4 m ² |
| CORRRIDOR | 10 m ² |
| BEDROOM | 17 m ² |
| MAID | 7 m ² |

UNIT TYPE - 2 BEDROOM • ISLAND

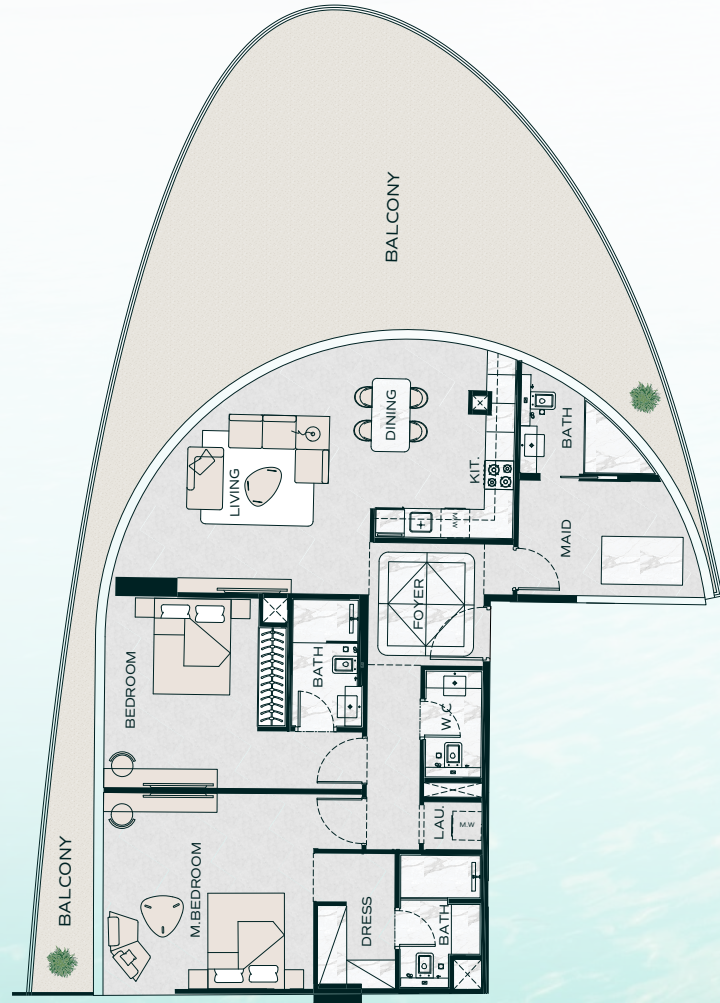

Disclaimer: 1. All room dimensions are measured to structural elements and exclude wall finishes and construction tolerances. 2. All dimensions have been provided by our consultant architects. 3. All materials, dimensions and drawings are approximate. Information is subject to change without notice. 4. Actual suite area may vary from the stated area. Drawings not to scale. The developer reserves the right to make revisions. 5. Calculation of suite area is measured as the area bounded by the centre line of demising or partition walls separating one unit from another unit, the exterior face of all exterior walls, and the exterior face of the corridor wall enclosing the adjoining unit. 6. Calculation of balcony area is measured as the area bounded by the centre line of demising or partition walls separating one unit from another unit, the outmost face of the enclosing guard and the external face of the adjoining balcony. 7. The units are measured at typical floor in the building. Columns may vary in size depending on the floor level. 8. For each unit type, unit sizes and details might be slightly different. Please refer to the sales and purchase agreement for the actual size of each specific unit.

2 BEDROOM TYPE 03

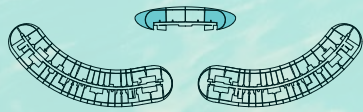

| AREA | SQ.M | SQ.FT |
|-----------------|-----------------------|-------------------------|
| AREA SUITE | 117.89 m ² | 1268.96 ft ² |
| BALCONY AREA | 75.63 m ² | 814.07 ft ² |
| TOTAL UNIT AREA | 193.52 m ² | 2083.03 ft ² |

FLAT DESIGN COMPONENTS

| | |
|------------------|-------------------|
| M.BATH | 4 m ² |
| M.BEDROOM | 24 m ² |
| LIVING | 21 m ² |
| KITCHEN & DINING | 12 m ² |
| BATH | 4 m ² |
| CORRRIDOR | 11 m ² |
| BEDROOM | 17 m ² |
| MAID | 9 m ² |
| LAUNDRY | 1 m ² |
| WC | 3 m ² |
| BATH | 4 m ² |

تنويه: ١. إن أبعاد الغرف يتم قياسها طبقاً للعناصر الهيكلية مع استبعاد تشطيبات الجدران ودرجة تحمل البناء. ٢. جميع القياسات تم تزويدها من قبل المهندسين المعماريين الاستشاريين لدينا. ٣. جميع المواد والأبعاد والرسومات تقريبية. تخضع المعلومات للتغيير دون إشعار مسبق. ٤. قد تختلف منطقة الجناح الفعلي عن المساحة المذكورة. الرسومات لا يتم توسيع نطاقها. يحتفظ المطور بالحق في إجراء التغييرات. ٥. يتم قياس حساب منطقة الجناح كمنطقة يحدها الخط المركزي للجدران الفاصلة أو الفاصلة التي تفصل وحدة عن وحدة أخرى، والوجه الخارجي لجميع الجدران الخارجية، والوجه الخارجي لحدار الممر المحيط بالوحدة المجاورة. ٦. ويقاس حساب منطقة الشرفة على أنها المنطقة التي يحدها الخط المركزي للجدران الفاصلة أو الفاصلة التي تفصل وحدة عن وحدة أخرى، والوجه الأبعد للحارس المرفق والوجه الخارجي للشرفة المجاورة. ٧. يتم قياس الوحدات في الطابق النموذجي في المبنى. قد تختلف الأعمدة في الحجم حسب مستوى الطابق. ٨. قد تكون أحجام الوحدات والتفاصيل المتعلقة بها مختلفة وذلك حسب نوع الوحدة. يرجى الرجوع إلى اتفاقية البيع والشراء لمعرفة الحجم الفعلي لكل وحدة.



UNIT TYPE - 3 BEDROOM

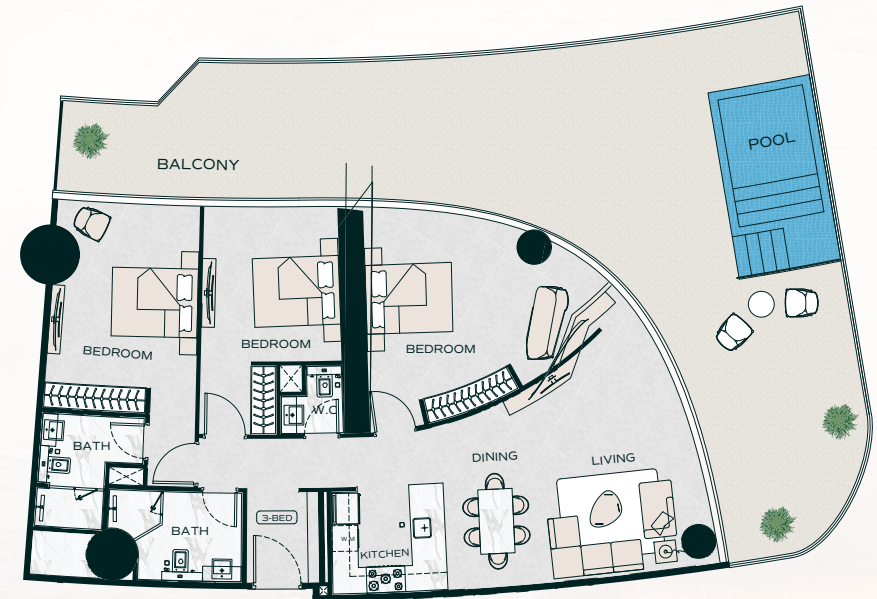
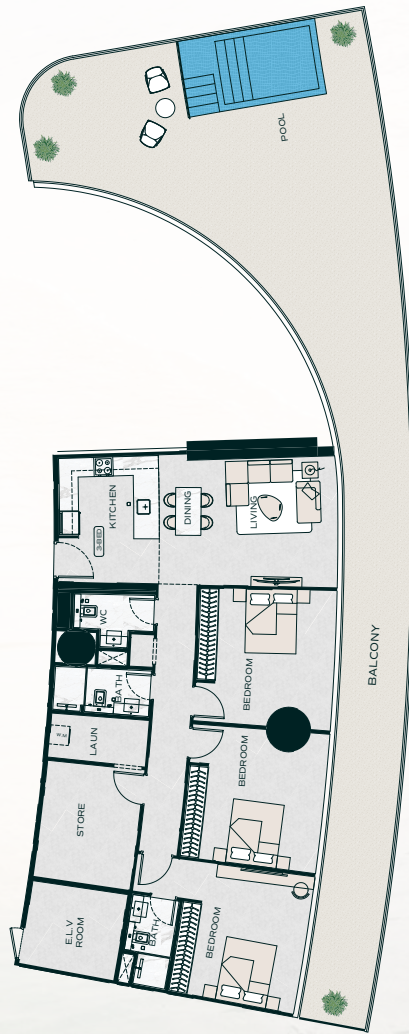

3-BEDROOM TYPE -01



| AREA | SQ.M | SQ.FT |
|-----------------|-----------------------|-------------------------|
| AREA SUITE | 46.141 m ² | 1524.60 ft ² |
| BALCONY AREA | 126.80 m ² | 1364.86 ft ² |
| TOTAL UNIT AREA | 268.44 m ² | 2889.46 ft ² |

FLAT DESIGN COMPONENTS

| | |
|-----------------|-------------------|
| LIVING & DINING | 23 m ² |
| KITCHEN | 31 m ² |
| W.C | 10 m ² |
| CORRIDOR | 4 m ² |
| M.BATH | 19 m ² |
| BATH | 4 m ² |
| BEDROOM | 18 m ² |
| BEDROOM | 18 m ² |
| STORE | 11 m ² |
| LAUNDRY | 4 m ² |
| WC | 3 m ² |

3-BEDROOM TYPE -02



| AREA | SQ.M | SQ.FT |
|-----------------|-----------------------|-------------------------|
| AREA SUITE | 46.141 m ² | 1524.60 ft ² |
| BALCONY AREA | 126.80 m ² | 1364.86 ft ² |
| TOTAL UNIT AREA | 268.44 m ² | 2889.46 ft ² |

FLAT DESIGN COMPONENTS

| | |
|-----------------|-------------------|
| LIVING & DINING | 23 m ² |
| KITCHEN | 31 m ² |
| W.C | 10 m ² |
| CORRIDOR | 4 m ² |
| M.BATH | 19 m ² |
| BATH | 4 m ² |
| BEDROOM | 18 m ² |
| BEDROOM | 18 m ² |
| STORE | 11 m ² |
| LAUNDRY | 4 m ² |
| WC | 3 m ² |

UNIT TYPE - 3 BEDROOM

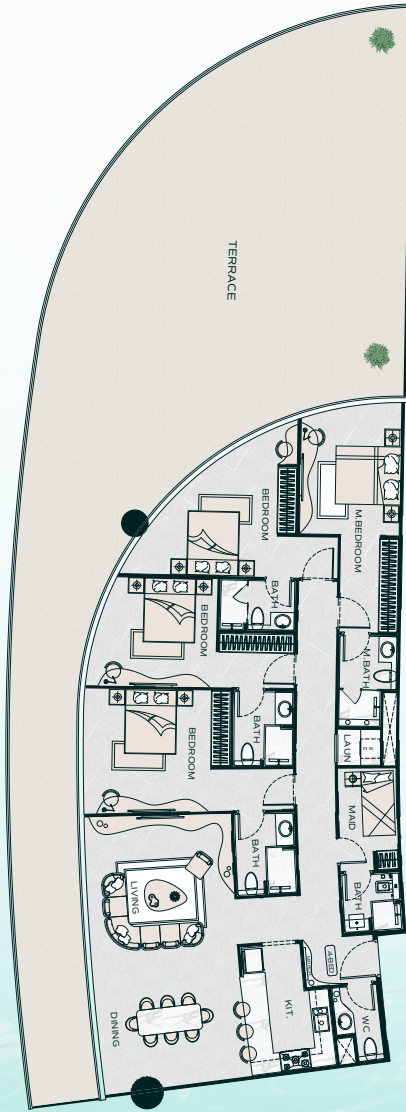

FLAT DESIGN COMPONENTS

| | |
|-----------------|-------------------|
| LIVING & DINING | 38 m ² |
| KITCHEN | 9 m ² |
| W.C | 3 m ² |
| CORRIDOR | 19 m ² |
| M.BEDROOM | 5 m ² |
| M.BATH | 17 m ² |
| BATH | 4 m ² |
| BEDROOM | 18 m ² |
| BEDROOM | 18 m ² |
| BATH | 4 m ² |
| LAUNDRY | 1 m ² |
| WC | 3 m ² |
| MAID | 6 m ² |

3-BEDROOM TYPE -03



| AREA | SQ.M | SQ.FT |
|-----------------|-----------------------|-------------------------|
| AREA SUITE | 184.82 m ² | 1989.39 ft ² |
| BALCONY AREA | 175.88 m ² | 1893.16 ft ² |
| TOTAL UNIT AREA | 360.70 m ² | 3882.54 ft ² |

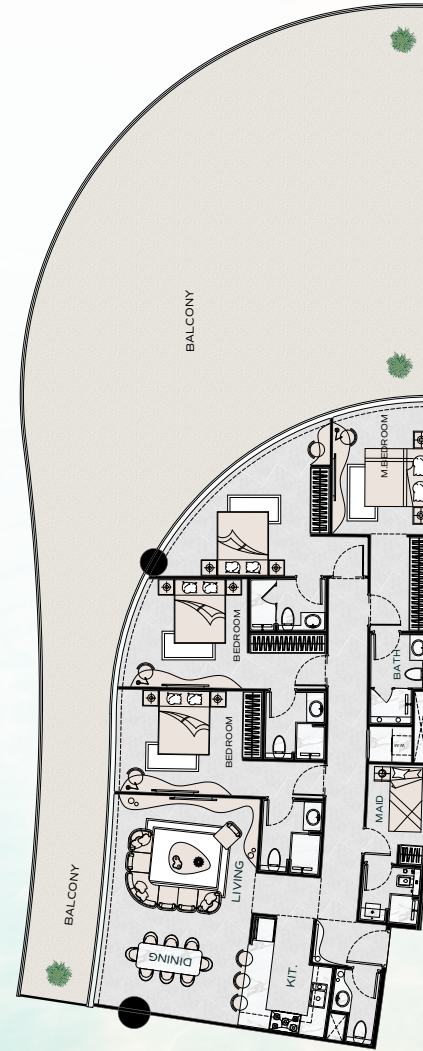

FLAT DESIGN COMPONENTS

| | |
|-----------------|-------------------|
| LIVING & DINING | 38 m ² |
| KITCHEN | 9 m ² |
| W.C | 3 m ² |
| CORRIDOR | 19 m ² |
| M.BEDROOM | 5 m ² |
| M.BATH | 17 m ² |
| BATH | 4 m ² |
| BEDROOM | 18 m ² |
| BEDROOM | 18 m ² |
| BATH | 4 m ² |
| LAUNDRY | 1 m ² |
| WC | 3 m ² |
| MAID | 6 m ² |

3-BEDROOM TYPE -04



| AREA | SQ.M | SQ.FT |
|-----------------|-----------------------|-------------------------|
| AREA SUITE | 170.45 m ² | 1834.71 ft ² |
| BALCONY AREA | 188.91 m ² | 2033.41 ft ² |
| TOTAL UNIT AREA | 359.36 m ² | 3868.12 ft ² |

UNIT TYPE - 3 BEDROOM

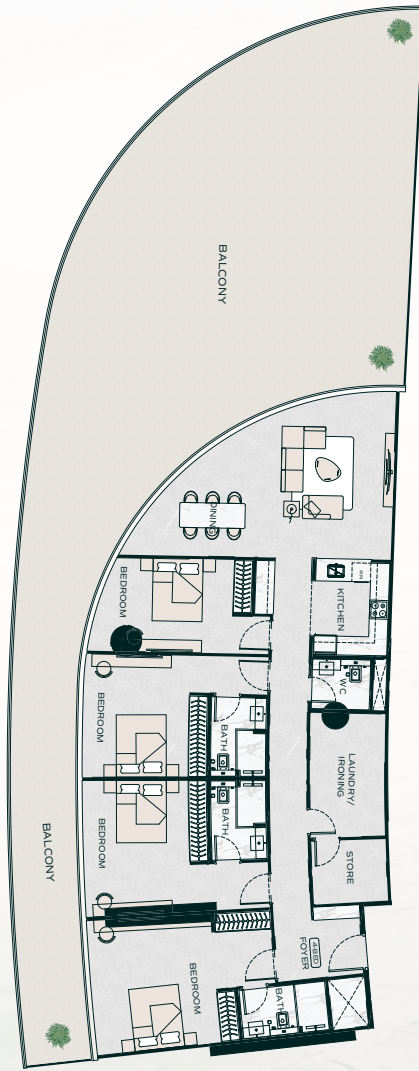

3-BEDROOM TYPE -05



| AREA | SQ.M | SQ.FT |
|-----------------|-----------------------|-------------------------|
| AREA SUITE | 183.83 m ² | 1978.73 ft ² |
| BALCONY AREA | 178.86 m ² | 1925.23 ft ² |
| TOTAL UNIT AREA | 362.69 m ² | 3903.96 ft ² |

FLAT DESIGN COMPONENTS

| | |
|-------------------|-------------------|
| LIVING & DINING | 33 m ² |
| KITCHEN | 8 m ² |
| W.C | 3 m ² |
| CORRIDOR | 21 m ² |
| M.BEDROOM | 5 m ² |
| M.BATH | 22 m ² |
| BATH | 5 m ² |
| BEDROOM | 20 m ² |
| BEDROOM | 20 m ² |
| BATH | 5 m ² |
| LAUNDRY & IRONING | 9 m ² |
| WC | 3 m ² |
| STORE | 5 m ² |



3-BEDROOM TYPE -06



| AREA | SQ.M | SQ.FT |
|-----------------|-----------------------|-------------------------|
| AREA SUITE | 169.06 m ² | 1819.75 ft ² |
| BALCONY AREA | 185.93 m ² | 2001.33 ft ² |
| TOTAL UNIT AREA | 354.99 m ² | 3821.08 ft ² |

FLAT DESIGN COMPONENTS

| | |
|-------------------|-------------------|
| LIVING & DINING | 33 m ² |
| KITCHEN | 8 m ² |
| W.C | 3 m ² |
| CORRIDOR | 21 m ² |
| M.BEDROOM | 5 m ² |
| M.BATH | 22 m ² |
| BATH | 5 m ² |
| BEDROOM | 20 m ² |
| BEDROOM | 20 m ² |
| BATH | 5 m ² |
| LAUNDRY & IRONING | 9 m ² |
| WC | 3 m ² |
| STORE | 5 m ² |

UNIT TYPE - 3 BEDROOM

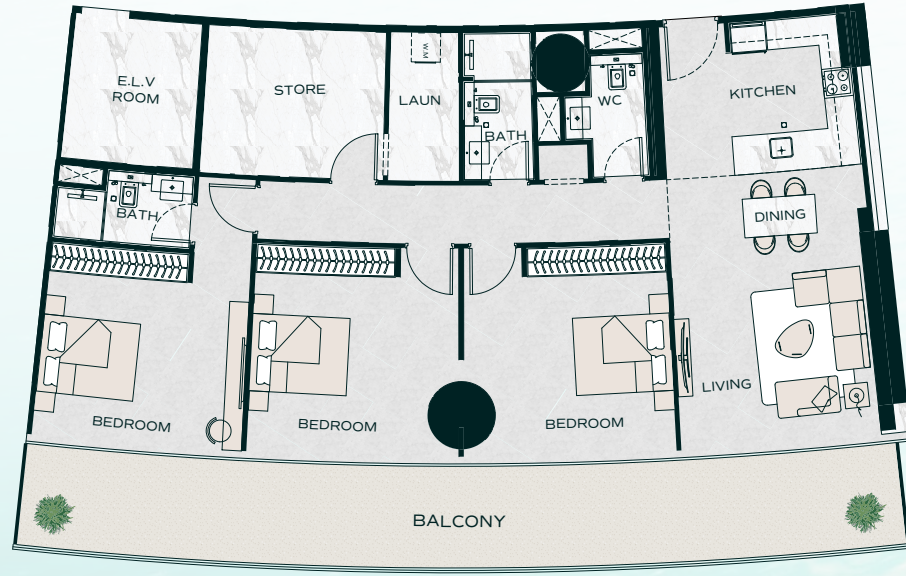

Disclaimer: 1. All room dimensions are measured to structural elements and exclude wall finishes and construction tolerances. 2. All dimensions have been provided by our consultant architects. 3. All materials, dimensions and drawings are approximate. Information is subject to change without notice. 4. Actual suite area may vary from the stated area. Drawings not to scale. The developer reserves the right to make revisions. 5. Calculation of suite area is measured as the area bounded by the centre line of demising or partition walls separating one unit from another unit, the exterior face of all exterior walls, and the exterior face of the corridor wall enclosing the adjoining unit. 6. Calculation of balcony area is measured as the area bounded by the centre line of demising or partition walls separating one unit from another unit, the outmost face of the enclosing guard and the external face of the adjoining balcony. 7. The units are measured at typical floor in the building. Columns may vary in size depending on the floor level. 8. For each unit type, unit sizes and details might be slightly different. Please refer to the sales and purchase agreement for the actual size of each specific unit.

3-BEDROOM TYPE -07

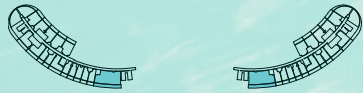

| AREA | SQ.M | SQ.FT |
|-----------------|-----------------------|-------------------------|
| AREA SUITE | 141.59 m ² | 1524.06 ft ² |
| BALCONY AREA | 39.72 m ² | 427.54 ft ² |
| TOTAL UNIT AREA | 181.31 m ² | 1951.60 ft ² |

FLAT DESIGN COMPONENTS

| | |
|-----------------|-------------------|
| LIVING & DINING | 23 m ² |
| KITCHEN | 13 m ² |
| W.C | 3 m ² |
| CORRIDOR | 10 m ² |
| M.BATH | 4 m ² |
| M.BEDROOM | 19 m ² |
| BATH | 4 m ² |
| BEDROOM | 18 m ² |
| BEDROOM | 18 m ² |
| BEDROOM | 18 m ² |
| STORE | 11 m ² |
| LAUNDRY | 4 m ² |
| WC | 3 m ² |

تنويه: ١. إن أبعاد الغرف يتم قياسها طبقاً للعناصر الهيكلية مع استبعاد تشطيبات الجدران ودرجة تحمل البناء. ٢. جميع القياسات تم تزويدها من قبل المهندسين المعماريين الاستشاريين لدينا. ٣. جميع المواد والأبعاد والرسومات تقريبية. تخضع المعلومات للتغيير دون إشعار مسبق. ٤. قد تختلف منطقة الجناح الفعلي عن المساحة المذكورة. الرسومات لا يتم توسيع نطاقها. يحتفظ المطور بالحق في إجراء التغييرات. ٥. يتم قياس حساب منطقة الجناح كمنطقة يحدها الخط المركزي للجدران الفاصلة أو الفاصلة التي تفصل وحدة عن وحدة أخرى، والوجه الخارجي لجميع الجدران الخارجية، والوجه الخارجي لجدار الممر المحيط بالوحدة المجاورة. ٦. ويقاس حساب منطقة الشرفة على أنها المنطقة التي يحدها الخط المركزي للجدران الفاصلة أو الفاصلة التي تفصل وحدة عن وحدة أخرى، والوجه الأبعد للحارس المرفق والوجه الخارجي للشرفة المجاورة. ٧. يتم قياس الوحدات في الطابق النموذجي في المبنى. قد تختلف الأعمدة في الحجم حسب مستوى الطابق. ٨. قد تكون أحجام الوحدات والتفاصيل المتعلقة بها مختلفة وذلك حسب نوع الوحدة. يرجى الرجوع إلى اتفاقية البيع والشراء لمعرفة الحجم الفعلي لكل وحدة.

UNIT TYPE - 3 BEDROOM • ISLAND

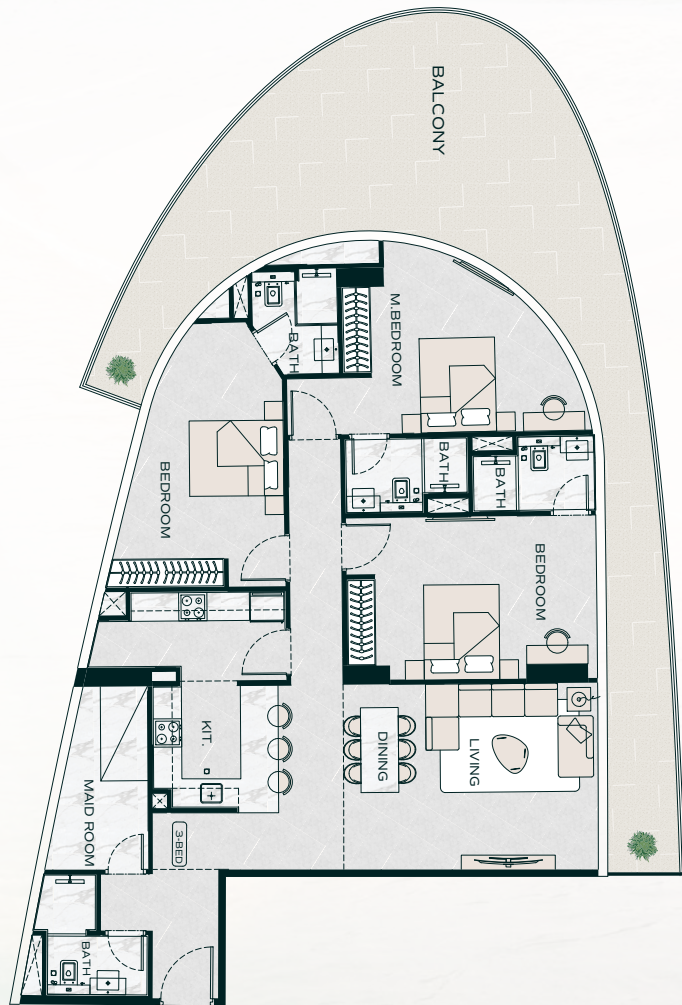

3 BEDROOM TYPE 01

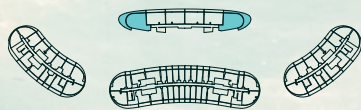

| AREA | SQ.M | SQ.FT |
|-----------------|-----------------------|-------------------------|
| AREA SUITE | 141.75 m ² | 1525.78 ft ² |
| BALCONY AREA | 62.29 m ² | 670.48 ft ² |
| TOTAL UNIT AREA | 204.04 m ² | 2196.27 ft ² |

FLAT DESIGN COMPONENTS

| | |
|-----------------|-------------------|
| LIVING & DINING | 21 m ² |
| KITCHEN | 15 m ² |
| CORRIDOR | 19 m ² |
| M.BATH | 5 m ² |
| M.BEDROOM | 17 m ² |
| BATH | 4 m ² |
| BEDROOM | 17 m ² |
| BEDROOM | 17 m ² |
| BATH | 4 m ² |
| MAID | 7 m ² |

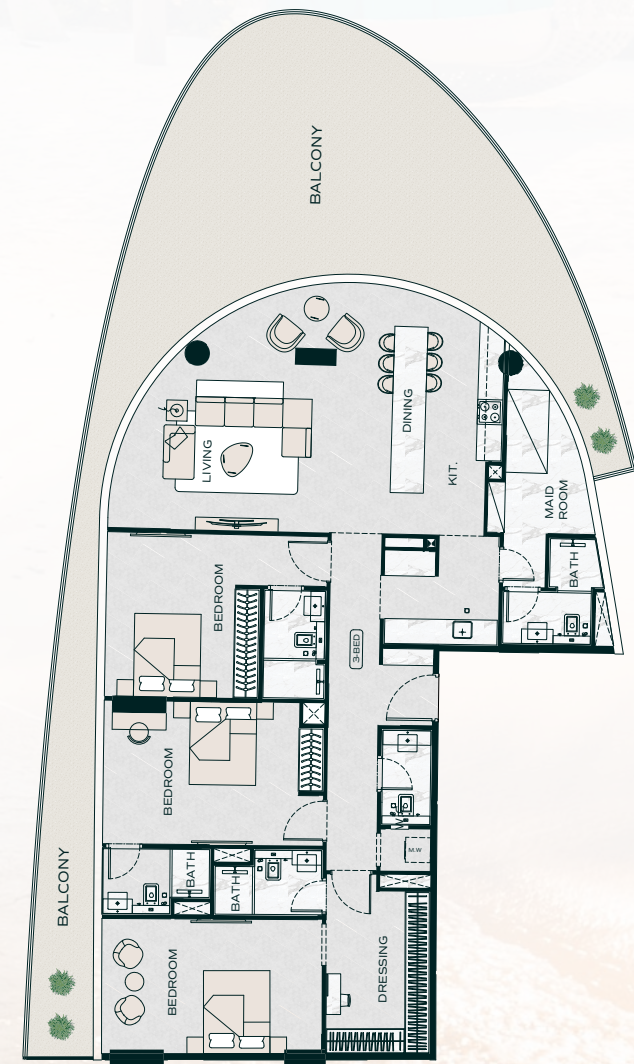

3 BEDROOM TYPE 02

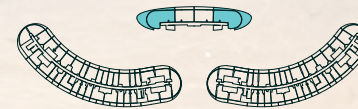

| AREA | SQ.M | SQ.FT |
|-----------------|-----------------------|-------------------------|
| AREA SUITE | 168.45 m ² | 1813.18 ft ² |
| BALCONY AREA | 84.02 m ² | 904.38 ft ² |
| TOTAL UNIT AREA | 252.47 m ² | 2717.56 ft ² |

FLAT DESIGN COMPONENTS

| | | | |
|-----------------|-------------------|---------|-------------------|
| LIVING & DINING | 41 m ² | BEDROOM | 18 m ² |
| KITCHEN | 14 m ² | BEDROOM | 16 m ² |
| CORRIDOR | 12 m ² | BATH | 4 m ² |
| M.BATH | 4 m ² | MAID | 8 m ² |
| M.BEDROOM | 27 m ² | LAUNDRY | 1 m ² |
| BATH | 4 m ² | WC | 3 m ² |

UNIT TYPE - 4 BEDROOM • ISLAND

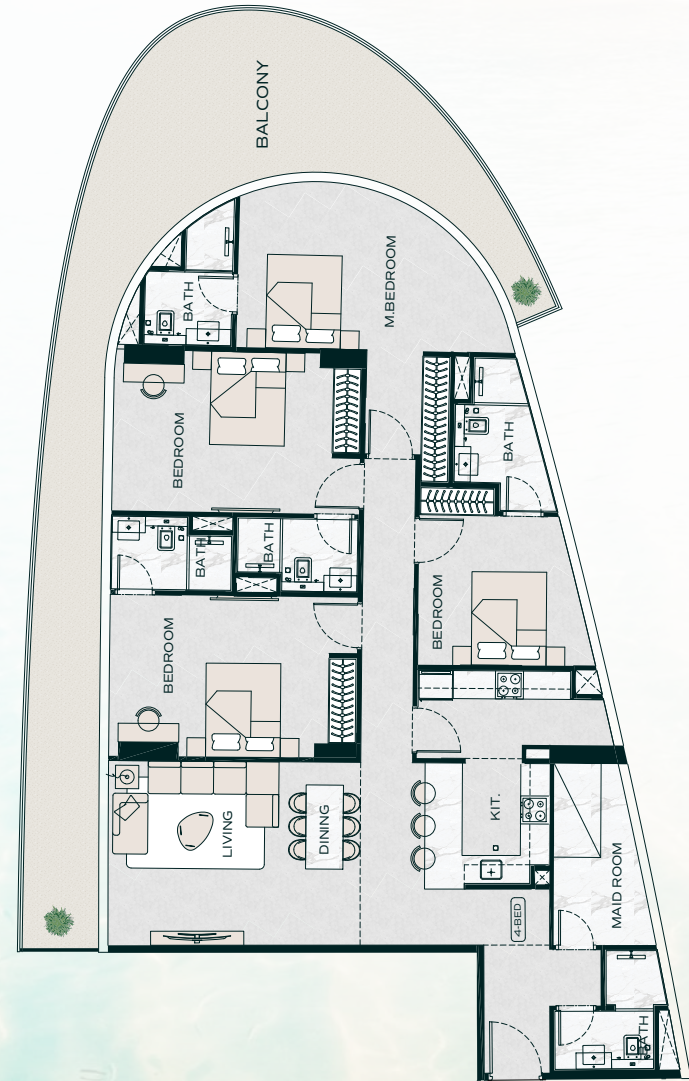
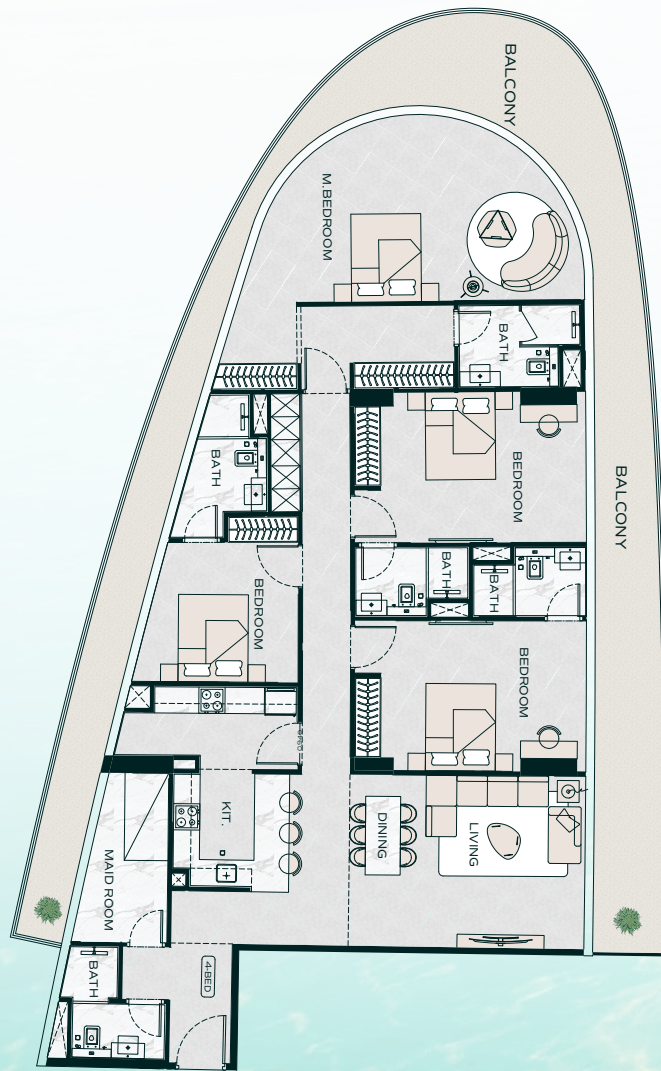

4 BEDROOM TYPE 01

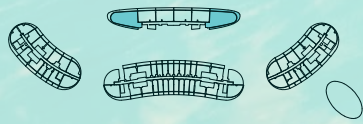

| AREA | SQ.M | SQ.FT |
|-----------------|-----------------------|-------------------------|
| AREA SUITE | 187.45 m ² | 2017.70 ft ² |
| BALCONY AREA | 65.06 m ² | 700.30 ft ² |
| TOTAL UNIT AREA | 252.51 m ² | 2718.00 ft ² |

FLAT DESIGN COMPONENTS

| | |
|-----------------|-------------------|
| LIVING & DINING | 21 m ² |
| KITCHEN | 15 m ² |
| CORRIDOR | 24 m ² |
| M.BATH | 5 m ² |
| M.BEDROOM | 37 m ² |
| BATH | 4 m ² |
| BEDROOM | 18 m ² |
| BEDROOM | 18 m ² |
| BATH | 4 m ² |
| MAID | 7 m ² |
| BATH | 4 m ² |
| BEDROOM | 12 m ² |
| BATH | 5 m ² |

4 BEDROOM TYPE 02

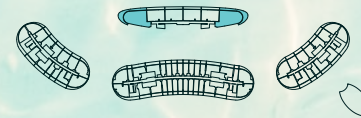

| AREA | SQ.M | SQ.FT |
|-----------------|-----------------------|-------------------------|
| AREA SUITE | 166.55 m ² | 1792.73 ft ² |
| BALCONY AREA | 55.04 m ² | 592.45 ft ² |
| TOTAL UNIT AREA | 221.59 m ² | 2385.17 ft ² |

FLAT DESIGN COMPONENTS

| | |
|-----------------|-------------------|
| LIVING & DINING | 21 m ² |
| KITCHEN | 15 m ² |
| CORRIDOR | 24 m ² |
| M.BATH | 5 m ² |
| M.BEDROOM | 37 m ² |
| BATH | 4 m ² |
| BEDROOM | 18 m ² |
| BEDROOM | 18 m ² |
| BATH | 4 m ² |
| MAID | 7 m ² |
| BATH | 4 m ² |
| BEDROOM | 12 m ² |
| BATH | 5 m ² |

Natural Finishes *and* Timeless Interiors



Travertine wall panels bring soft texture, brushed brass accents add warmth, and natural oak wood grounds the space in calm sophistication. Every detail is thoughtfully chosen to create a refined, welcoming atmosphere.





ABOUT THE BRAND

A Legacy *of* Architectural Artistry

As a distinguished Emirati property brand, Binghatti has carved a niche for itself by creating iconic landmarks that redefine the skyline.

The brand's diverse portfolio caters to a wide spectrum of discerning clientele, offering projects that range from accessible elegance to ultra-high-end luxury. Binghatti's signature design DNA, meticulously woven into each development, sets it apart on the global stage.

With over **79 projects** in the region valued at more than **AED 50 billion**, Binghatti is a leading privately held developer in the UAE. The company's impressive track record, including the successful delivery of **20,000 units** prior to 2024, underscores its dedication to crafting exceptional living spaces.

Through groundbreaking collaborations with prestigious luxury brands such as **BUGATTI, Mercedes-Benz,** and **Jacob & Co.**, Binghatti continues to push boundaries and set new benchmarks in the world of branded real estate.

Muhammad Binghatti



 **BINGHATTI**

B E S P O K E

Bespoke Living Binghatti *Style*

EXPERT PROPERTY SERVICES
ALL UNDER ONE ROOF



PROPERTY
MANAGEMENT



UNIT RESALE



PARKING
SALE



HOLIDAY
HOMES



ANNUAL
MAINTENANCE



FURNITURE
PACKAGES



ONE SCAN
ALL SOLUTION

 Binghatti

 Binghattiofficial

 Binghatti

 Binghatti





A Dream in Blue,
Waiting *to be* Discovered.

Recall the crystal shores of the azure coast.
Where elegance reigned. Aquarise. A dream in
blue, waiting to be discovered.

Recall the Crystal Shores
of the Azure Coast

 بن غاطي
BINGHATTI